

ADDRESSING KEY PLAN REQUIREMENTS FOR COMMERCIAL/INDUSTRIAL SITES

An addressing key plan is a simple line drawing (on 11x17 paper) detailing the following items:

- All buildings located on the property including property lines.
- All proposed or assigned civic unit addressing.
- The demising walls that separate the different units in the building.
- All abutting city street names.
- North arrow.

Note: Google images are **not** accepted.

Civic Addressing/Building Numbering

- The City of Saskatoon assigns all civic addressing (building and unit numbering).
- Commercial/Industrial site civic addressing is largely dependent on the location of the site, site access and location of the buildings on site.
- The City of Saskatoon uses the term “unit” for all commercial and residential spaces (bay, suite, etc. are not used).
- Contact commercial.permits@saskatoon.ca to have preliminary civic addressing reviewed.
- Building and Development Permit applications are required to include preliminary civic addressing.

Single Storey Multi-Tenant Building

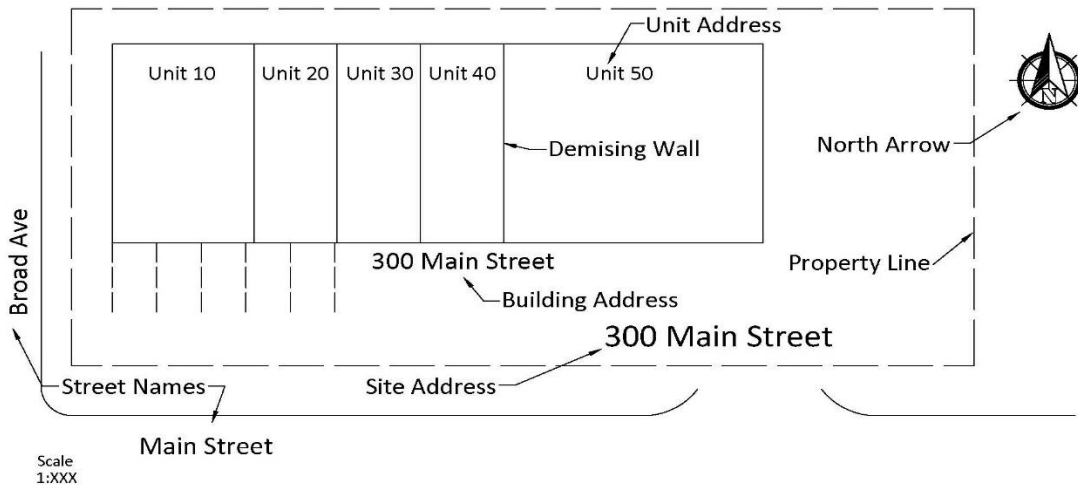

Scale
1:XXX

Multi-Storey Multi-Tenant Building

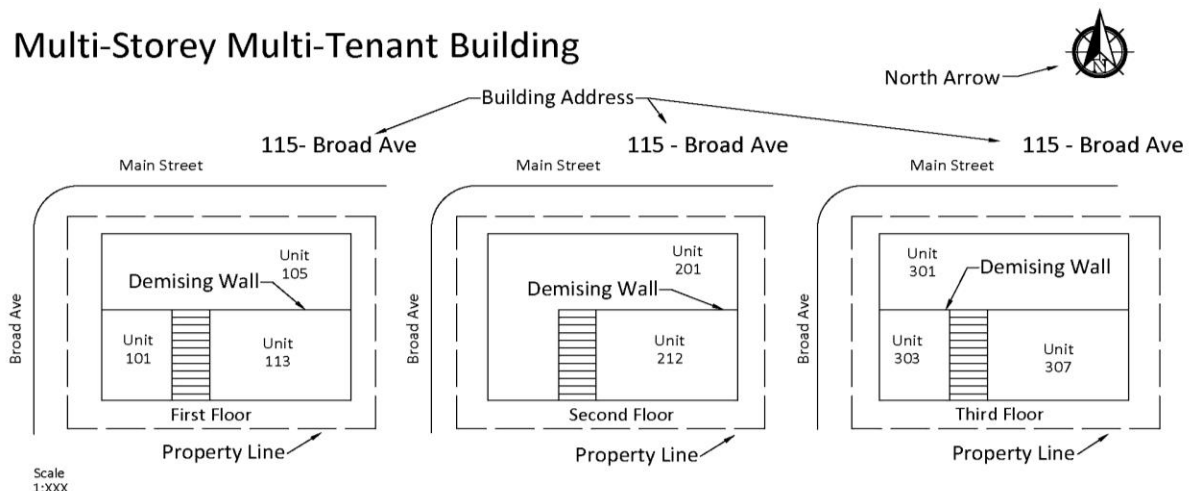

Scale
1:XXX