

ADDRESSING KEY / SITE PLAN

An addressing key plan is a simple scaled line drawing detailing the following items:

- All buildings located on the property including property lines.
- All proposed or assigned civic unit addressing.
- The demising walls that separate the different units in the building.
- All abutting city street names.
- North arrow.

Note: Google images are **not** accepted.

Civic Addressing/Building Numbering

- The City of Saskatoon assigns all civic addressing (building and unit numbering) for purposes of wayfinding and emergency response time.
- Commercial/Industrial site civic addressing is largely dependent on the location of the site, site access and location of the buildings on site.
- The City of Saskatoon uses the term “unit” for all commercial and residential spaces (bay, suite, etc. are not used).
- Contact commercial.permits@saskatoon.ca to have preliminary civic addressing reviewed.
- Building and Development Permit applications are required to include preliminary civic addressing.

Single Storey Multi-Tenant Building

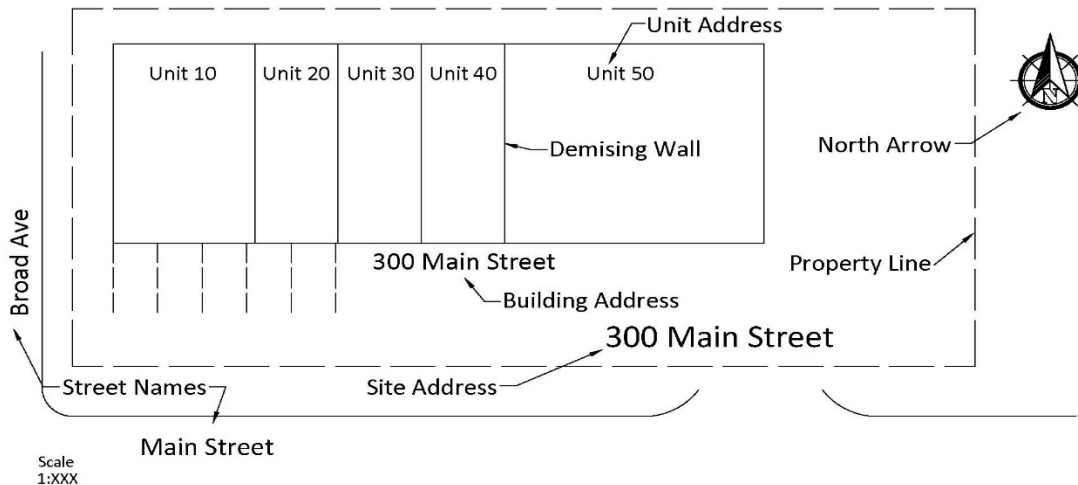

Multi-Storey Multi-Tenant Building

