



December 4, 2017

CITY OF SASKATOON

Asbestos-Containing Building Materials Assessment Report - Mayfair Lawn Bowling Clubhouse



Submitted to:

The City of Saskatoon
1101 Avenue P North
Saskatoon, SK S7L 7K6

Report Number: 1667963

Distribution:

One Copy: City of Saskatoon
One Copy: Golder Associates Ltd.

REPORT





Table of Contents

1.0 INTRODUCTION	1
2.0 SCOPE OF WORK	1
2.1 Asbestos-Containing Materials	1
3.0 RESULTS AND DISCUSSION	2
3.1 Asbestos-Containing Materials	2
3.1.1 List of Identified Asbestos-Containing Materials	2
3.1.2 Non Asbestos-Containing Materials	3
4.0 EXCLUDED AREAS AND MATERIALS	3
5.0 CONCLUSIONS AND RECOMMENDATIONS	3
5.1 Asbestos-Containing Materials	3
6.0 SURVEY LIMITATIONS	4
7.0 CLOSURE	5
APPENDICES	
APPENDIX A Laboratory Certificate of Analysis Report	
APPENDIX B Site Photographs	
APPENDIX C Mayfair Lawn Bowling Clubhouse Room by Room Spreadsheet	
APPENDIX D Floor Plan	



1.0 INTRODUCTION

Golder Associates Ltd. (Golder) was retained by the City of Saskatoon (the Client) to conduct an asbestos-containing building materials assessment of the Mayfair Lawn Bowling Clubhouse (the Site) located at 915 Avenue D North in Saskatoon, Saskatchewan. This assessment report details our findings, conclusions and recommendations for the Site. A walkthrough of the Site was conducted on September 13, 2017 and the assessment was conducted on October 16, 2017 by Kody Henderson, OHS Project Manager. Asbestos-containing building materials were identified within the Mayfair Lawn Bowling Clubhouse during the assessment. Further information is provided in Section 3.0.

2.0 SCOPE OF WORK

In accordance with Tender 16-0844, Golder's scope of work included conducting an asbestos-containing building materials assessment of the Site to evaluate the quantities, locations, and conditions of asbestos-containing building materials.

Following the field work, Golder prepared this assessment report that includes laboratory analysis results, findings of the assessment, conclusions, and recommendations.

2.1 Asbestos-Containing Materials

The assessment involved a non-destructive inspection of the Site to assess the type and extent of suspect ACMs in the facility. The systems that were reviewed as part of the inspections included, but were not limited to:

- *Structural* - systems including: insulation between solid webbed joists, fireproofing, building envelope, and interior/exterior caulking around windows and doors;
- *Mechanical* - systems insulation including: hot water and steam system, condensate system, chilled water system, glycol system, domestic hot and cold water, emergency generator exhaust, boiler units, heat exchangers, and asbestos cement piping; and
- *Architectural* - systems including: texture coats, sheet flooring, vinyl floor tile, acoustical spray-applied materials, condensation control applications, ceiling tile, wall board, drywall joint compound, and asbestos sheet products.

Systematic sampling of suspect ACMs was conducted as part of the assessment. Samples were submitted under chain of custody to International Asbestos Testing Laboratory Inc. (IATL) and analyzed for asbestos type and percentage content using Polarized Light Microscopy (PLM) in accordance with EPA methodologies (EPA 600/R-93/116).

Further information related to the assessment and sample collection methods can be found in the Golder document *Golder Asbestos Assessment General Survey Plan and Protocol* provided to the Client.



3.0 RESULTS AND DISCUSSION

The Mayfair Lawn Bowling Clubhouse consists of a lounge, office, washrooms, locker room, and storage and mechanical rooms and was constructed in 1981. During the assessment, the entire building was treated as one functional space.

- The Laboratory Certificate of Analysis report for the bulk asbestos samples is included in Appendix A.
- Photographs collected during the assessment are provided in Appendix B.
- A room by room spreadsheet outlining the locations, quantities, friability, and condition of identified asbestos-containing materials as well as additional information is provided in Appendix C.
- Floor plans outlining the sample locations and locations of identified asbestos-containing materials is provided in Appendix D.
- Please refer to Sections 4.0 and 6.0 of this report for a summary of the limitations encountered.

3.1 Asbestos-Containing Materials

A total of eleven (11) samples of building materials were collected and tested for asbestos content during the assessment of the Mayfair Lawn Bowling Clubhouse. Two (2) of the samples were found to contain asbestos.

Potential asbestos-containing components may be located within the electrical panels on Site.

3.1.1 List of Identified Asbestos-Containing Materials

A list of the identified asbestos-containing materials is provided below.

- 12"x12" Beige Floor Tile with Brown Streaks; and
- Silver Sink Undercoat.

Further information on the identified asbestos-containing materials listed is provided below.

12"x12" Beige Floor Tile with Brown Streaks

One (1) sample of 12"x12" beige floor tile with brown streaks was collected during the assessment. The sample collected was found to contain 2.3% Chrysotile asbestos. Asbestos-containing 12"x12" beige floor tile with brown streaks (see Photograph 1 in Appendix B) was observed in the following locations:

- Room 102 (approximately 230 ft²);
- Room 103 (approximately 35 ft²);
- Room 104 (approximately 150 ft²);
- Room 106 (approximately 40 ft²);
- Room 107 (approximately 150 ft²); and
- Room 108 (approximately 10 ft²).

Additional asbestos-containing 12"x12" beige floor tile with brown streaks may be located below the carpet in other areas of the Site.



Silver Sink Undercoat

One (1) sample of silver sink undercoat was collected during the assessment. The sample collected was found to contain 1.7% Chrysotile asbestos. Asbestos-containing silver sink undercoat (see Photograph 2 in Appendix B) was observed in the following location:

- Room 102 (approximately 3 sinks).

3.1.2 Non Asbestos-Containing Materials

The following materials were sampled during this assessment and were found to not contain asbestos or were observed to be non-suspect materials:

- Brick mortar;
- White building caulking;
- Drywall joint compound;
- The piping and duct work was observed to be uninsulated in the accessible locations; and
- The walls were observed to be constructed of concrete block and drywall with non-asbestos-containing joint compound with ceilings constructed of drywall with non-asbestos-containing joint compound. The flooring was observed to be a mix of carpet, concrete, rubber mats, and asbestos-containing floor tiles.

4.0 EXCLUDED AREAS AND MATERIALS

The following is a list of the areas and/or materials excluded during the assessment.

- The roof and associated components were not assessed by Golder during the assessment as per Tender 16-0844. If the roof and associated components are to be removed or impacted by future renovation or demolition activities, additional investigation and sampling of suspect materials may be required.
- The block walls were not assessed by Golder during the assessment as per Tender 16-0844. If the block walls are to be removed or impacted by future renovation or demolition activities, additional investigation and sampling of suspect materials may be required.
- The electrical panels and associated components were not inspected by Golder during the assessment. If the panels are to be removed or impacted by future renovation or demolition activities, additional investigation and sampling of suspect materials may be required.

5.0 CONCLUSIONS AND RECOMMENDATIONS

Based on the visual assessment and the laboratory analytical results, the following project specific conclusions and recommendations are provided.

5.1 Asbestos-Containing Materials

Asbestos was positively identified within the 12"x12" beige floor tile with brown streaks and the silver sink undercoat on Site. Asbestos was not identified in the remaining samples collected and analyzed.

If the building is scheduled for renovations that will impact the identified or potential asbestos-containing materials, it must be removed. If additional suspect asbestos-containing building materials are encountered during renovation activities, additional sampling should be undertaken to evaluate asbestos content.



Removal work should be completed by workers that are adequately trained in the hazards and proper methods of working with asbestos. Throughout the abatement activities, appropriate air monitoring and inspections should be conducted by a competent person to document that contamination is contained and that ACM are disposed of appropriately. Ensure asbestos waste is disposed of in accordance with the requirements of the Government of Saskatchewan.

All quantities listed in the report are approximate and are based on the conditions at the time of the assessment. Prior to abatement work it is recommended that a competent person conduct a review of the site to quantify and obtain all measurements of all building materials detailed in this report for cost estimating purposes.

In anticipation of potential abatement, Golder's recommendations for the asbestos-containing materials identified during the assessment are outlined below.

12"x12" Beige Floor Tile with Brown Streaks

If scheduled for impact, asbestos-containing 12"x12" beige floor tile with brown streaks should be abated following low-risk abatement work procedures as outlined in the *Saskatchewan Asbestos Abatement Manual* (2017). Alternatively, as the 12"x12" beige floor tile with brown streaks was observed in good condition, and with a priority rating of 5 (please see the room by room spreadsheet provided in Appendix C for a description of the priority ratings), it can be managed in place if not scheduled for impact.

Silver Sink Undercoat

If scheduled for impact, asbestos-containing silver sink undercoat should be abated following low-risk abatement work procedures as outlined in the *Saskatchewan Asbestos Abatement Manual* (2017). Alternatively, as the silver sink undercoat was observed in good condition, and with a priority rating of 5 (please see the room by room spreadsheet provided in Appendix C for a description of the priority ratings), it can be managed in place if not scheduled for impact.

6.0 SURVEY LIMITATIONS

This report is based on data and information collected by Golder during the assessment conducted on October 16, 2017 and is based solely on site conditions encountered at the time of the assessment. Any use of this document or the findings, conclusions or recommendations provided in this report by any person other than the City of Saskatoon is at the sole risk of such user.

The conclusions and recommendations contained in this survey report are based upon professional opinions with regard to the subject matter. These opinions are in accordance with currently accepted environmental assessment standards and practices applicable to these locations and are subject to the following inherent limitations:

The data and findings presented in this report are valid as of the dates of the investigations. The passage of time, manifestation of latent conditions or occurrence of future events may warrant further exploration at the properties, analysis of the data, and re-evaluation of the findings, observations, and conclusions expressed in this report. No assurance is made regarding changes in conditions or practices subsequent to the time of the investigation. It was beyond the scope of this assessment to conduct a risk assessment and the potential health risks that may be associated with asbestos exposure for building occupants.



ASBESTOS-CONTAINING BUILDING MATERIALS ASSESSMENT REPORT - MAYFAIR LAWN BOWLING CLUBHOUSE

The data reported and the findings, observations and conclusions expressed in this report are limited by the Scope of Work. The Scope of Work was defined by Tender 16-0844 and the initial site walkthrough with the Client, the time and budgetary constraints imposed by the Client, and availability of access to the property.

Because of the limitations stated above, the findings, observations and conclusions expressed by Golder in this report are not, and must not be, considered an opinion concerning compliance of any past or present owner or operator of the site with any federal, provincial or local laws or regulations.

No warranty or guarantee, whether expressed or implied, is made with respect to the data or the reported findings, observations, and conclusions, which are based solely upon site conditions in existence at the time of investigation.

Golder's assessment reports present professional opinions and findings of a scientific and technical nature. While attempts were made to relate the data and findings to applicable environmental laws and regulations, the report shall not be construed to offer legal opinion or representations as to the requirements of, nor compliance with, environmental laws, rules, regulations or policies of federal, provincial, or local governmental agencies. Any use of the survey report constitutes acceptance of the limits of Golder's liability.

Golder's liability extends only to its client and not to other parties who may obtain this survey report. Issues raised by the report must be reviewed by appropriate legal counsel.

7.0 CLOSURE

We trust the information presented in this report meets your requirements. If you have any questions, please contact Kody Henderson at (780) 483-3499 or email at kody_henderson@golder.com. Thank you for the opportunity to be of service. We look forward to working with you again in the future.



Report Signature Page

GOLDER ASSOCIATES LTD.

Prepared by:

Reviewed by:

Handwritten signature of Kody Henderson in black ink.

Kody Henderson, Dipl. Env. Sci., CRSP
OHS Project Manager

Handwritten signature of Andrew Grant in black ink.

Andrew Grant, B.Sc., P.Eng., EP, CRSP
Associate, OHS Project Director

KH/AG/ba

Golder, Golder Associates and the GA globe design are trademarks of Golder Associates Corporation.

\\golder\galliedmonton\active\2016\3 proj\1667963 cityofsaskatoon_asbsurveys_saskatoon\07 reports\79 - mayfair lawn bowling clubhouse\city of saskatoon - mayfair lawn bowling clubhouse - asbestos building material assessment report.docx



APPENDIX A

Laboratory Certificate of Analysis Report

CERTIFICATE OF ANALYSIS

Client: Golder Associates Ltd
16820 107 Ave
Edmonton AB T5P 4C3

Report Date: 11/1/2017
Report No.: 550476 - PLM
Project: Mayfair Lawn Bowling Clubhouse
Project No.: 1667963

Client: GOL572

PLM BULK SAMPLE ANALYSIS SUMMARY

Lab No.: 6372439	Analyst Observation: Orange Brick	Location: Exterior
Client No.: A-001	Client Description: Brick Mortar	Facility:
<u>Percent Asbestos:</u> <i>None Detected</i>	<u>Percent Non-Asbestos Fibrous Material:</u> None Detected	<u>Percent Non-Fibrous Material:</u> 100

Lab No.: 6372440	Analyst Observation: Orange Brick	Location: Exterior
Client No.: A-002	Client Description: Brick Mortar	Facility:
<u>Percent Asbestos:</u> <i>None Detected</i>	<u>Percent Non-Asbestos Fibrous Material:</u> None Detected	<u>Percent Non-Fibrous Material:</u> 100

Lab No.: 6372441	Analyst Observation: Orange Brick	Location: Exterior
Client No.: A-003	Client Description: Brick Mortar	Facility:
<u>Percent Asbestos:</u> <i>None Detected</i>	<u>Percent Non-Asbestos Fibrous Material:</u> None Detected	<u>Percent Non-Fibrous Material:</u> 100

Lab No.: 6372441(L2)	Analyst Observation: White/Green Paint	Location: Exterior
Client No.: A-003	Client Description: Brick Mortar	Facility:
<u>Percent Asbestos:</u> <i>None Detected</i>	<u>Percent Non-Asbestos Fibrous Material:</u> None Detected	<u>Percent Non-Fibrous Material:</u> 100

Lab No.: 6372442	Analyst Observation: Tan Caulk	Location: Exterior
Client No.: A-004	Client Description: White Building Caulking	Facility:
<u>Percent Asbestos:</u> <i>None Detected</i>	<u>Percent Non-Asbestos Fibrous Material:</u> None Detected	<u>Percent Non-Fibrous Material:</u> 100

Lab No.: 6372443	Analyst Observation: White Joint Compound	Location: Room 100
Client No.: A-005	Client Description: Drywall Joint Compound	Facility:
<u>Percent Asbestos:</u> <i>None Detected</i>	<u>Percent Non-Asbestos Fibrous Material:</u> None Detected	<u>Percent Non-Fibrous Material:</u> 100

Analytical Method -US EPA 600, R93-116. Please refer to the Appendix of this report for further information regarding your analysis.

Date Received: 10/24/2017
Date Analyzed: 11/01/2017
Signature: 
Analyst: Ellen Smith

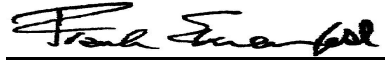
Approved By: 
Frank E. Ehrenfeld, III
Laboratory Director

CERTIFICATE OF ANALYSIS

Client: Golder Associates Ltd
16820 107 Ave
Edmonton AB T5P 4C3

Report Date: 11/1/2017
Report No.: 550476 - PLM
Project: Mayfair Lawn Bowling Clubhouse
Project No.: 1667963

Client: GOL572

Appendix to Analytical Report

Customer Contact:

Analysis: US EPA 600, R93-116

This appendix seeks to promote greater understanding of any observations, exceptions, special instructions, or circumstances that the laboratory needs to communicate to the client concerning the above samples. The information below is used to help promote your ability to make the most informed decisions for you and your customers. Please note the following points of contact for any questions you may have.

iATL Customer Service: customerservice@iatl.com

iATL Office Manager: cdavis@iatl.com

iATL Account Representative: Pete Lesniak

Sample Login Notes: See Batch Sheet Attached

Sample Matrix: Bulk Building Materials

Exceptions Noted: See Following Pages

General Terms, Warrants, Limits, Qualifiers:

General information about iATL capabilities and client/laboratory relationships and responsibilities are spelled out in iATL policies that are listed at www.iATL.com and in our Quality Assurance Manual per ISO 17025 standard requirements. The information therein is a representation of iATL definitions and policies for turnaround times, sample submittal, collection media, blank definitions, quantification issues and limit of detection, analytical methods and procedures, sub-contracting policies, results reporting options, fees, terms, and discounts, confidentiality, sample archival and disposal, and data interpretation.

iATL warrants the test results to be of a precision normal for the type and methodology employed for each sample submitted. iATL disclaims any other warrants, expressed or implied, including warranty of fitness for a particular purpose and warranty of merchantability. iATL accepts no legal responsibility for the purpose for which the client uses test results. Any analytical work performed must be governed by our Standard Terms and Conditions. Prices, methods and detection limits may be changed without notification. Please contact your Customer Service Representative for the most current information.

This confidential report relates only to those item(s) tested and does not represent an endorsement by NIST-NVLAP, AIHA LAP LLC, or any agency of local, state or province governments nor of any agency of the U.S. government.

This report shall not be reproduced except in full, without written approval of the laboratory.

Information Pertinent to this Report:

Analysis by US EPA 600 93-116: Determination of Asbestos in Bulk Building Materials by Polarized Light Microscopy (PLM).

Certifications:

- NIST-NVLAP No. 101165-0
- NY-DOH No. 11021
- AIHA-LAP, LLC No. 100188

Quantification at <0.25% by volume is possible with this method. (PC) Indicates Stratified Point Count Method performed. (PC-Trace) means that asbestos was detected but is not quantifiable under the Point Counting regimen. Analysis includes all distinct separable layers in accordance with EPA 600 Method. If not reported or otherwise noted, layer is either not present or the client has specifically requested that it not be analyzed (ex. analyze until positive instructions). Small asbestos fibers may be missed by PLM due to resolution limitations of the optical microscope. Therefore, PLM is not consistently reliable in detecting asbestos in non-friable organically bound (NOB) materials. Quantitative transmission electron microscopy (TEM) is currently the only method that can pronounce materials as non-asbestos containing.

Analytical Methodology Alternatives: Your initial request for analysis may not have accounted for recent advances in regulatory requirements or advances in technology that are routinely used in similar situations for other qualified projects. You may have the option to explore additional analysis for further information. Below are a few options, listed as the matrix followed by the appropriate methodology. Also included are links to more information on our website.

Bulk Building Materials that are Non-Friable Organically Bound (NOB) by Gravimetric Reduction techniques employing PLM and TEM: ELAP 198.6 (PLM-NOB), ELAP 198.4 (TEM-NOB)

Loose Fill Vermiculite Insulation, Attic Insulation, Zonolite (copyright), etc.: US EPA 600 R-4/004 (multi-tiered analytical process)
Sprayed On Insulation/Fireproofing with Vermiculite (SOF-V): ELAP 198.8 (PLM-SOF-V)>

CERTIFICATE OF ANALYSIS

Client: Golder Associates Ltd
16820 107 Ave
Edmonton AB T5P 4C3

Client: GOL572

Report Date: 11/1/2017
Report No.: 550476 - PLM
Project: Mayfair Lawn Bowling Clubhouse
Project No.: 1667963

Soil, sludge, sediment, aggregate, and like materials analyzed for asbestos or other elongated mineral particles (ex. erionite, etc.): ASTM D7521, CARB 435, and other options available

Asbestos in Surface Dust according to one of ASTM's Methods (very dependent on sampling collection technique – by TEM): ASTM D 5755, D5756, or D6480

Various other asbestos matrices (air, water, etc.) and analytical methods are available.

Disclaimers / Qualifiers:

There may be some samples in this project that have a "NOTE:" associated with a sample result. We use added disclaimers or qualifiers to inform the client about something that requires further explanation. Here is a list with highlighted disclaimers that may be pertinent to this project. For a full explanation of these and other disclaimers, please inquire at customerservice@iatl.com.

- 1) Note: No mastic provided for analysis.
- 2) Note: Insufficient mastic provided for analysis.
- 3) Note: Insufficient material provided for analysis.
- 4) Note: Insufficient sample provided for QC reanalysis.
- 5) Note: Different material than indicated on Sample Log / Description.
- 6) Note: Sample not submitted.
- 7) Note: Attached to asbestos containing material.
- 8) Note: Received wet.
- 9) Note: Possible surface contamination.
- 10) Note: Not building material. 1% threshold may not apply.
- 11) Note: Recommend TEM-NOB analysis as per EPA recommendations.
- 12) Note: Asbestos detected but not quantifiable.
- 13) Note: Multiple identical samples submitted, only one analyzed.
- 14) Note: Analyzed by EPA 600/R-93/116. Point Counting detection limit at 0.080%.
- 15) Note: Analyzed by EPA 600/R-93/116. Point Counting detection limit at 0.125%.

Recommendations for Vermiculite Analysis:

Several analytical protocols exist for the analysis of asbestos in vermiculite. These analytical approaches vary depending upon the nature of the vermiculite mineral being tested (e.g. un-processed gange, homogeneous exfoliated books of mica, or mixed mineral composites). Please contact your client representative for pricing and turnaround time options available.

iATL recommends initial testing using the EPA 600/R-93/116 method. This method is specifically designed for the analysis of asbestos in bulk building materials. It provides an acceptable starting point for primary screening of vermiculite for possible asbestos.

Results from this testing may be inconclusive. EPA suggests proceeding to a multi-tiered analysis involving wet separation techniques in conjunction with PLM and TEM gravimetric analysis (EPA 600/R-04/004).

Further information on this method and other vermiculite and asbestos issues can be found at the following: Agency for Toxic Substances and Disease Registry (ATSDR) www.atsdr.cdc.gov, United States Geological Survey (USGS) www.minerals.usgs.gov/minerals/, US EPA www.epa.gov/asbestos. The USEPA also has an informative brochure "Current Best Practices for Vermiculite Attic Insulation" EPA 747F03001 May 2003, that may assist the health and remediation professional.

The following is a summary of the analytical process outlines in the EPA 600/R-04/004 Method:

- 1) **Analytical Step/Method:** Initial Screening by PLM, EPA 600R-93/116
Requirements/Comments: Minimum of 0.1 g of sample. ~0.25% LOQ for most samples.
- 2) **Analytical Step/Method:** Wet Separation by PLM Gravimetric Technique, EPA R-04/004
Requirements/Comments: Minimum 50g** of dry sample. Analysis of "Sinks" only.
- 3) **Analytical Step/Method:** Wet Separation by PLM Gravimetric Technique, EPA R-04/004
Requirements/Comments: Minimum 50g** of dry sample. Analysis of "Floats" only.
- 4) **Analytical Step/Method:** Wet Separation by TEM Gravimetric Technique, EPA R-04/004
Requirements/Comments: Minimum 50g** of dry sample. Analysis of "Sinks" only.
- 5) **Analytical Step/Method:** Wet Separation by TEM Gravimetric Technique, EPA R-04/004

CERTIFICATE OF ANALYSIS

Client: Golder Associates Ltd
16820 107 Ave
Edmonton AB T5P 4C3

Client: GOL572

Report Date: 11/1/2017
Report No.: 550476 - PLM
Project: Mayfair Lawn Bowling Clubhouse
Project No.: 1667963

Requirements/Comments: Minimum 50g** of dry sample. Analysis of "Suspension" only.

LOQ, Limit of Quantitation estimates for mass and volume analyses.

*With advance notice and confirmation by the laboratory.

**Approximately 1 Liter of sample in double-bagged container (~9x6 inch bag of sample).



APPENDIX B

Site Photographs



APPENDIX B
Site Photographs



Photograph 1: Asbestos-Containing 12"x12" Beige Floor Tile with Brown Streaks.



Photograph 2: Asbestos-Containing Silver Sink Undercoat.

\\golder\galledmonton\active\2016\3 proj\1667963 cityofsaskatoon_asbsurveys_saskatoon\07 reports\79 - mayfair lawn bowling clubhouse\appendix b - mayfair lawn bowling ch - site photographs.docx



APPENDIX C

Mayfair Lawn Bowling Clubhouse Room by Room Spreadsheet

Appendix C
Mayfair Lawn Bowling Clubhouse
ACM Inventory

Included/Excluded	Floor	Room #	Area Description	Elements	Subelements	Material Description	Accessibility	Suspect?	Sampled?	Asbestos Containing Material?	Condition	Field Notes	Sample Type	Sample ID	Sample Date	Asbestos Type	ACM Product	% of asbestos	Friable	Sprayed-on	Maintenance	Inspection	Priority	Potential for Disturbance	Recommended Action	Quantity	Photograph ID	Labelling Type	
Included	M	All	All	Doors	Regular Door	Non Suspect Door	High	No	No	No	Good	Non-suspect doors.																	
Included	M	100	Lounge	Walls	Walls	Concrete Block	High	No	No	No	Good		Bulk	A-005	16-Oct-17														
Included	M	100	Lounge	Walls	Walls	Drywall Joint Compound	High	No	Yes	No	Good																		
Included	M	100	Lounge	Floor	Floor	Carpet	High	No	No	No	Good																		
Included	M	100	Lounge	Ceiling	Ceiling	Drywall Joint Compound	High	No	Yes	No	Good																		
Included	M	100	Lounge	Mechanical	Duct	Bare Duct Work	High	No	No	No	Good																		
Included	M	100	Lounge	Windows	Caulking	No Window Caulking Observed	High	No	No	No	Good																		
Included	M	101	Office	Walls	Walls	Concrete Block	High	No	No	No	Good																		
Included	M	101	Office	Walls	Walls	Drywall Joint Compound	High	No	Yes	No	Good																		
Included	M	101	Office	Floor	Floor	Carpet	High	No	No	No	Good																		
Included	M	101	Office	Ceiling	Ceiling	Drywall Joint Compound	High	No	Yes	No	Good																		
Included	M	101	Office	Windows	Caulking	No Window Caulking Observed	High	No	No	No	Good																		
Included	M	102	Kitchen	Walls	Walls	Drywall Joint Compound	High	No	Yes	No	Good																		
Included	M	102	Kitchen	Floor	Floor	12"x12" Beige Floor Tile with Brown Streaks	High	Yes	Yes	Yes	Good						Chrysotile	Floor Tile	2.30%	No	No	No	Annually	5	Moderate	Manage in place.	230 ft ²	Photograph 1	Door Jamb
Included	M	102	Kitchen	Ceiling	Ceiling	Drywall Joint Compound	High	No	Yes	No	Good																		
Included	M	102	Kitchen	Plumbing	Sink	Silver Sink Undercoat	High	Yes	Yes	Yes	Good		Bulk	A-011	16-Oct-17	Chrysotile	Silver Sink Undercoat	1.70%	No	No	No	Annually	5	Moderate	Manage in place.	3 Sinks	Photograph 2	Door Jamb	
Included	M	103	Vestibule	Walls	Walls	Drywall Joint Compound	High	No	Yes	No	Good		Bulk	A-006	16-Oct-17														
Included	M	103	Vestibule	Floor	Floor	12"x12" Beige Floor Tile with Brown Streaks	High	Yes	Yes	Yes	Good						Chrysotile	Floor Tile	2.30%	No	No	No	Annually	5	Moderate	Manage in place.	35 ft ²	Photograph 1	Door Jamb
Included	M	103	Vestibule	Ceiling	Ceiling	Drywall Joint Compound	High	No	Yes	No	Good																		
Included	M	104	Washroom	Walls	Walls	Concrete Block	High	No	No	No	Good																		
Included	M	104	Washroom	Walls	Walls	Drywall Joint Compound	High	No	Yes	No	Good																		
Included	M	104	Washroom	Floor	Floor	12"x12" Beige Floor Tile with Brown Streaks	High	Yes	Yes	Yes	Good						Chrysotile	Floor Tile	2.30%	No	No	No	Annually	5	Moderate	Manage in place.	150 ft ²	Photograph 1	Door Jamb
Included	M	104	Washroom	Ceiling	Ceiling	Drywall Joint Compound	High	No	Yes	No	Good																		
Included	M	105	Furnace Room	Walls	Walls	Drywall Joint Compound	High	No	Yes	No	Good		Bulk	A-007	16-Oct-17														
Included	M	105	Furnace Room	Floor	Floor	Concrete	High	No	No	No	Good																		
Included	M	105	Furnace Room	Ceiling	Ceiling	Drywall Joint Compound	High	No	Yes	No	Good																		
Included	M	105	Furnace Room	Mechanical	Piping	Uninsulated Piping	High	No	No	No	Good																		
Included	M	105	Furnace Room	Electrical	Electrical	Electrical Panel and Components	High	Yes	No	Potential	Good	Not sampled due to safety concerns.																	
Included	M	106	Vestibule	Walls	Walls	Drywall Joint Compound	High	No	Yes	No	Good																		
Included	M	106	Vestibule	Floor	Floor	12"x12" Beige Floor Tile with Brown Streaks	High	Yes	Yes	Yes	Good						Chrysotile	Floor Tile	2.30%	No	No	No	Annually	5	Moderate	Manage in place.	40 ft ²	Photograph 1	Door Jamb
Included	M	106	Vestibule	Ceiling	Ceiling	Drywall Joint Compound	High	No	Yes	No	Good																		
Included	M	107	Washroom	Walls	Walls	Concrete Block	High	No	No	No	Good																		
Included	M	107	Washroom	Walls	Walls	Drywall Joint Compound	High	No	Yes	No	Good																		
Included	M	107	Washroom	Floor	Floor	12"x12" Beige Floor Tile with Brown Streaks	High	Yes	Yes	Yes	Good						Chrysotile	Floor Tile	2.30%	No	No	No	Annually	5	Moderate	Manage in place.	150 ft ²	Photograph 1	Door Jamb
Included	M	107	Washroom	Ceiling	Ceiling	Drywall Joint Compound	High	No	Yes	No	Good																		
Included	M	108	Janitor Room	Walls	Walls	Drywall Joint Compound	High	No	Yes	No	Good		Bulk	A-008	16-Oct-17														
Included	M	108	Janitor Room	Floor	Floor	12"x12" Beige Floor Tile with Brown Streaks	High	Yes	Yes	Yes	Good		Bulk	A-009	16-Oct-17	Chrysotile	Floor Tile	2.30%	No	No	No	Annually	5	Moderate	Manage in place.	10 ft ²	Photograph 1	Door Jamb	
Included	M	108	Janitor Room	Ceiling	Ceiling	Drywall Joint Compound	High	No	Yes	No	Good																		
Included	M	109	Storage Room	Walls	Walls	Concrete Block	High	No	No	No	Good																		
Included	M	109	Storage Room	Floor	Floor	Concrete	High	No	No	No	Good																		
Included	M	109	Storage Room	Floor	Floor	Rubber Mats	High	No	No	No	Good																		
Included	M	109	Storage Room	Ceiling	Ceiling	Wood	High	No	No	No	Good																		
Included	M	109	Storage Room	Electrical	Electrical	Electrical Panel and Components	High	Yes	No	Potential	Good	Not sampled due to safety concerns.																	
Included	M	110	Locker Room	Walls	Walls	Concrete Block	High	No	No	No	Good																		
Included	M	110	Locker Room	Walls	Walls	Drywall Joint Compound	High	No	Yes	No	Good																		
Included	M	110	Locker Room	Floor	Floor	Carpet	High	No	No	No	Good																		
Included	M	110	Locker Room	Ceiling	Ceiling	Drywall Joint Compound	High	No	Yes	No	Good		Bulk	A-010	16-Oct-17														
Included	E	Exterior	Exterior	Walls	Walls	Brick Mortar	High	No	Yes	No	Good		Bulk	A-003	16-Oct-17														
Included	E	Exterior	Exterior	Walls	Caulking	White Building Caulking	High	No	Yes	No	Good		Bulk	A-004	16-Oct-17														
Excluded		Exterior	Roof	Exterior Roof	Exterior Roof							Not assessed due to scope of work.																	



APPENDIX D

Floor Plan

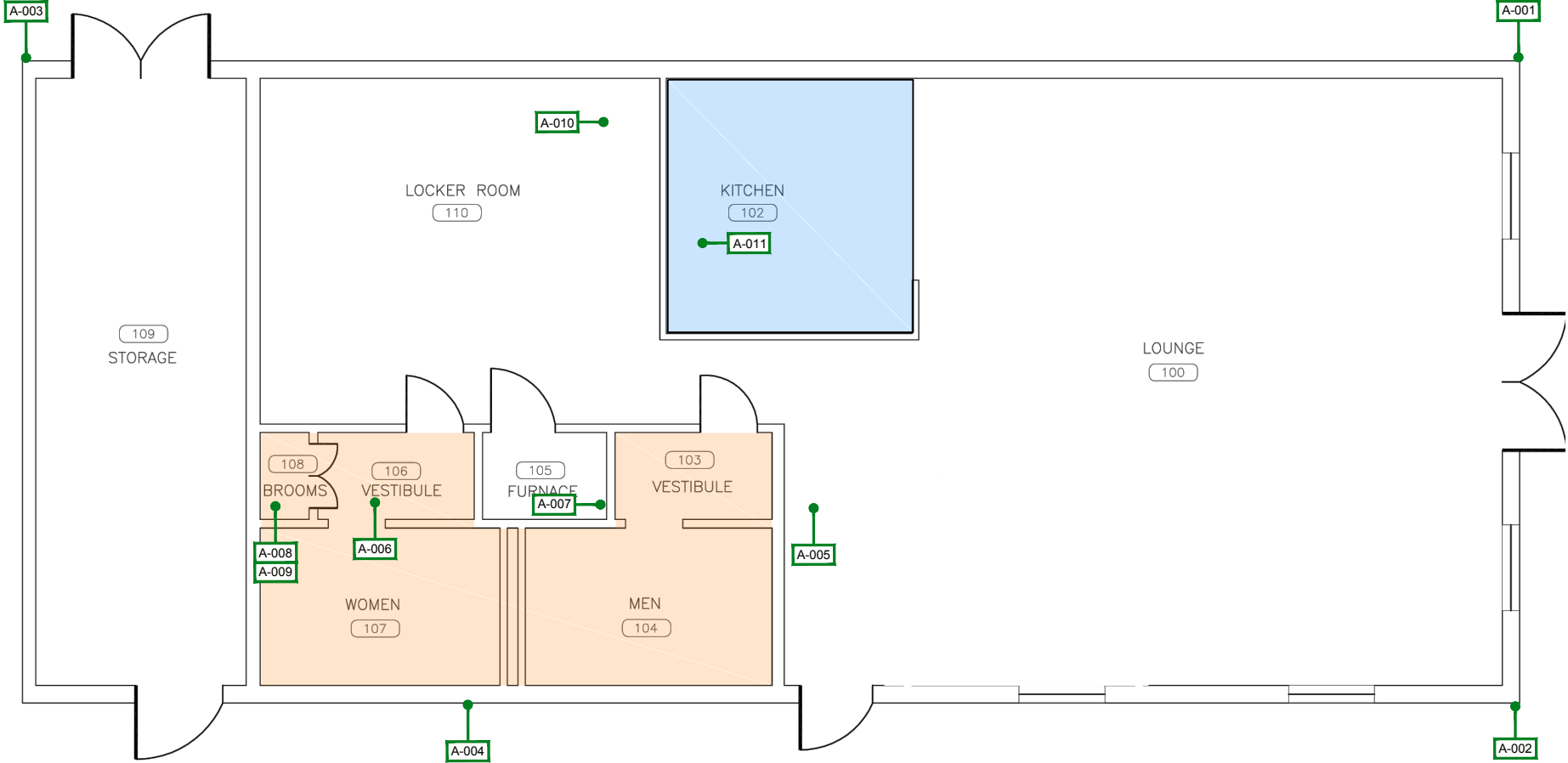

LEGEND

	ASBESTOS SAMPLE LOCATION
	ASBESTOS - CONTAINING FLOOR TILE
	ASBESTOS - CONTAINING FLOOR TILE AND SINK UNDERCOAT

NOTE(S)
 1. ASBESTOS IS A CARCINOGEN. DO NOT BREATHE ASBESTOS DUST.

REFERENCE(S)
 PLAN OBTAINED FROM INFRASTRUCTURE SERVICES DEPARTMENT CITY OF SASKATOON. DATED: 02/11/2016.

CLIENT
 CITY OF SASKATOON

CONSULTANT



YYYY-MM-DD	2017-12-01
DESIGNED	KH
PREPARED	VI
REVIEWED	KH
APPROVED	AG

SCHEMATIC ONLY, NOT TO SCALE

PROJECT
 ASBESTOS ASSESSMENT
 MAYFAIR LAWN BOWLING CLUBHOUSE
 915 AVENUE D NORTH

TITLE
MAIN FLOOR

PROJECT NO.	CONTROL	REV.	FIGURE
1667963	1000-HM-0001	0	1

IF THIS MEASUREMENT DOES NOT MATCH WHAT IS SHOWN, THE SHEET SIZE HAS BEEN MODIFIED FROM: ANSI A

26 mm

As a global, employee-owned organisation with over 50 years of experience, Golder Associates is driven by our purpose to engineer earth's development while preserving earth's integrity. We deliver solutions that help our clients achieve their sustainable development goals by providing a wide range of independent consulting, design and construction services in our specialist areas of earth, environment and energy.

For more information, visit golder.com

Africa	+ 27 11 254 4800
Asia	+ 86 21 6258 5522
Australasia	+ 61 3 8862 3500
Europe	+ 356 21 42 30 20
North America	+ 1 800 275 3281
South America	+ 56 2 2616 2000

solutions@golder.com
www.golder.com

Golder Associates Ltd.
16820 107 Avenue
Edmonton, Alberta, T5P 4C3
Canada
T: +1 (780) 483 3499

