



November 24, 2017

CITY OF SASKATOON

Asbestos-Containing Building Materials Assessment Report - Supernatant Valve Chamber



REPORT

Submitted to:

The City of Saskatoon
1101 Avenue P North
Saskatoon, SK S7L 7K6

Report Number: 1667963

Distribution:

One Copy: City of Saskatoon
One Copy: Golder Associates Ltd.





Table of Contents

1.0 INTRODUCTION	1
2.0 SCOPE OF WORK	1
2.1 Asbestos-Containing Materials	1
3.0 RESULTS AND DISCUSSION	2
3.1 Asbestos-Containing Materials	2
3.1.1 Non Asbestos-Containing Materials	2
4.0 EXCLUDED AREAS AND MATERIALS	2
5.0 CONCLUSIONS AND RECOMMENDATIONS	3
5.1 Asbestos-Containing Materials	3
6.0 SURVEY LIMITATIONS	3
7.0 CLOSURE	4

APPENDICES

APPENDIX A

Laboratory Certificate of Analysis

APPENDIX B

Supernatant Valve Chamber – ACM Inventory

APPENDIX C

Floor Plan



1.0 INTRODUCTION

Golder Associates Ltd. (Golder) was retained by the City of Saskatoon (the Client) to conduct an asbestos-containing building materials assessment of the Supernatant Valve Chamber (the Site) located in Saskatoon, Saskatchewan. This assessment report details our findings, conclusions and recommendations for the Site. A walkthrough of the Site was conducted on September 7, 2017 by Kody Henderson, OHS Project Manager, and the assessment was conducted on October 18, 2017 by Scott Bishop, Junior Occupational Hygienist. Asbestos-containing building materials were not identified within the Supernatant Valve Chamber during the assessment. Further information is provided in Section 3.0.

2.0 SCOPE OF WORK

In accordance with Tender 16-0844, Golder's scope of work included conducting an asbestos-containing building materials assessment of the Site to evaluate the quantities, locations, and conditions of asbestos-containing building materials.

Following the field work, Golder prepared this assessment report that includes laboratory analysis results, findings of the assessment, conclusions, and recommendations.

2.1 Asbestos-Containing Materials

The assessment involved a non-destructive inspection of the Site to assess the type and extent of suspect ACMs in the facility. The systems that were reviewed as part of the inspections included, but were not limited to:

- *Structural* - systems including: insulation between solid webbed joists, fireproofing, building envelope, and interior/exterior caulking around windows and doors;
- *Mechanical* - systems insulation including: hot water and steam system, condensate system, chilled water system, glycol system, domestic hot and cold water, emergency generator exhaust, boiler units, heat exchangers, and asbestos cement piping; and
- *Architectural* - systems including: texture coats, sheet flooring, vinyl floor tile, acoustical spray-applied materials, condensation control applications, ceiling tile, wall board, drywall joint compound, and asbestos sheet products.

Systematic sampling of suspect ACMs was conducted as part of the assessment. Samples were submitted under chain of custody to International Asbestos Testing Laboratory Inc. (IATL) and analyzed for asbestos type and percentage content using Polarized Light Microscopy (PLM) in accordance with EPA methodologies (EPA 600/R-93/116).

Further information related to the assessment and sample collection methods can be found in the Golder document *Golder Asbestos Assessment General Survey Plan and Protocol* provided to the Client.



3.0 RESULTS AND DISCUSSION

The Supernatant Valve Chamber consists of equipment rooms, and was constructed in 1984. During the assessment, the entire building was treated as one functional space.

- The Laboratory Certificate of Analysis report for the bulk asbestos samples is included in Appendix A.
- A room by room spreadsheet outlining the locations, quantities, friability, and condition of identified asbestos-containing materials as well as additional information is provided in Appendix B.
- A floor plan is provided in Appendix C.
- Please refer to Sections 4.0 and 6.0 of this report for a summary of the limitations encountered.

3.1 Asbestos-Containing Materials

A total of three (3) samples of building materials were collected and tested for asbestos content during the assessment of the Supernatant Valve Chamber. None of the samples were found to contain asbestos.

3.1.1 Non Asbestos-Containing Materials

The following materials were sampled during this assessment and were found to not contain asbestos or were observed to be non-suspect materials:

- White caulking;
- Exterior grey firestop putty; and,
- Exterior white caulking.

The attic space was visually assessed from the access hatch on the main floor. The attic was observed to be insulated with fiberglass insulation. Loose-fill vermiculite insulation was not observed below the insulation in the areas within reach from the access hatch.

No further suspect asbestos-containing materials were observed during the assessment. The area was observed to have a concrete floor with plastic panels on the walls and a wood ceiling.

4.0 EXCLUDED AREAS AND MATERIALS

The following is a list of the areas and/or materials excluded during the assessment.

- Building materials accessible by a ten foot ladder were assessed by Golder during the assessment. Materials located at heights that were inaccessible from a ten foot ladder were not assessed. If materials at heights are to be removed or impacted by future renovation or demolition activities, additional investigation and sampling of suspect materials may be required.
- The roof and associated components were not assessed by Golder during the assessment as per Tender 16-0844. If the roof and associated components are to be removed or impacted by future renovation or demolition activities, additional investigation and sampling of suspect materials may be required.
- Electrical components were not assessed by Golder during the assessment as per Tender 16-0844. If the electrical components are to be removed or impacted by future renovation or demolition activities, additional investigation and sampling of suspect materials may be required.



- The attic space was assessed from the ceiling hatch and loose-fill vermiculite was not observed. However, as Golder did not enter the attic space, there is potential for loose-fill vermiculite insulation to be present in other areas of the attic.

5.0 CONCLUSIONS AND RECOMMENDATIONS

Based on the visual assessment, the following project specific conclusions and recommendations are provided.

5.1 Asbestos-Containing Materials

No suspect asbestos-containing materials were observed within the Supernatant Valve Chamber.

If suspect asbestos-containing building materials are encountered during renovation or demolition activities, sampling should be undertaken to evaluate asbestos content.

6.0 SURVEY LIMITATIONS

This report is based on data and information collected by Golder during the assessment conducted on October 18, 2017 and is based solely on site conditions encountered at the time of the assessment. Any use of this document or the findings, conclusions or recommendations provided in this report by any person other than the City of Saskatoon is at the sole risk of such user.

The conclusions and recommendations contained in this survey report are based upon professional opinions with regard to the subject matter. These opinions are in accordance with currently accepted environmental assessment standards and practices applicable to these locations and are subject to the following inherent limitations:

The data and findings presented in this report are valid as of the dates of the investigations. The passage of time, manifestation of latent conditions or occurrence of future events may warrant further exploration at the properties, analysis of the data, and re-evaluation of the findings, observations, and conclusions expressed in this report. No assurance is made regarding changes in conditions or practices subsequent to the time of the investigation. It was beyond the scope of this assessment to conduct a risk assessment and the potential health risks that may be associated with asbestos exposure for building occupants.

The data reported and the findings, observations and conclusions expressed in this report are limited by the Scope of Work. The Scope of Work was defined by Tender 16-0844 and the initial site walkthrough with the Client, the time and budgetary constraints imposed by the Client, and availability of access to the property.

Because of the limitations stated above, the findings, observations and conclusions expressed by Golder in this report are not, and must not be, considered an opinion concerning compliance of any past or present owner or operator of the site with any federal, provincial or local laws or regulations.

No warranty or guarantee, whether expressed or implied, is made with respect to the data or the reported findings, observations, and conclusions, which are based solely upon site conditions in existence at the time of investigation.

Golder's assessment reports present professional opinions and findings of a scientific and technical nature. While attempts were made to relate the data and findings to applicable environmental laws and regulations, the report shall not be construed to offer legal opinion or representations as to the requirements of, nor compliance with, environmental laws, rules, regulations or policies of federal, provincial, or local governmental agencies. Any use of the survey report constitutes acceptance of the limits of Golder's liability.



ASBESTOS-CONTAINING BUILDING MATERIALS ASSESSMENT REPORT - SUPERNATANT MAINTENANCE SHOP

Golder's liability extends only to its client and not to other parties who may obtain this survey report. Issues raised by the report must be reviewed by appropriate legal counsel.

7.0 CLOSURE

We trust the information presented in this report meets your requirements. If you have any questions, please contact Kody Henderson at (780) 483-3499 or email at kody_henderson@golder.com. Thank you for the opportunity to be of service. We look forward to working with you again in the future.



Report Signature Page

GOLDER ASSOCIATES LTD.

Prepared by:

Scott Bishop, B.A.
Junior Occupational Hygienist

Reviewed by:

Kody Henderson, Dipl. Env. Sci., CRSP
OHS Project Manager

Reviewed by:

Andrew Grant, B.Sc., P.Eng., EP, CRSP
Associate, OHS Project Director

SWB/KH/AG/ba

Golder, Golder Associates and the GA globe design are trademarks of Golder Associates Corporation.

\\golder\gal\edmonton\active\2016\3 proj\1667963 cityofsaskatoon_asbsurveys_saskatoon\07 reports\109 - supernatant valve station\city of saskatoon - supernatant valve chamber - asbestos building material assessment report.docx



APPENDIX A

Laboratory Certificate of Analysis

CERTIFICATE OF ANALYSIS

Client: Golder Associates Ltd
16820 107 Ave
Edmonton AB T5P 4C3

Report Date: 10/31/2017
Report No.: 550354 - PLM
Project: City of Saskatoon: Supernatant Valve Station
Project No.: 1667963

Client: GOL572

PLM BULK SAMPLE ANALYSIS SUMMARY

Lab No.: 6370991
Client No.: A-001

Analyst Observation: White Caulk
Client Description: White Window Caulking

Location: Interior
Facility:

Percent Asbestos:
None Detected

Percent Non-Asbestos Fibrous Material:
None Detected

Percent Non-Fibrous Material:
100

Lab No.: 6370992
Client No.: A-002

Analyst Observation: Grey Putty
Client Description: Grey Firestop Putty

Location: Exterior
Facility:

Percent Asbestos:
None Detected

Percent Non-Asbestos Fibrous Material:
None Detected

Percent Non-Fibrous Material:
100

Lab No.: 6370993
Client No.: A-003

Analyst Observation: White Caulk
Client Description: White Caulking

Location: Exterior
Facility:

Percent Asbestos:
None Detected

Percent Non-Asbestos Fibrous Material:
None Detected

Percent Non-Fibrous Material:
100

Analytical Method -US EPA 600, R93-116. Please refer to the Appendix of this report for further information regarding your analysis.

Date Received: 10/23/2017

Approved By:

Date Analyzed: 10/31/2017

Frank E. Ehrenfeld, III
Laboratory Director

Signature:
Analyst: Nick Daigle

CERTIFICATE OF ANALYSIS

Client: Golder Associates Ltd
16820 107 Ave
Edmonton AB T5P 4C3

Report Date: 10/31/2017
Report No.: 550354 - PLM
Project: City of Saskatoon: Supernatant Valve
Station
Project No.: 1667963

Client: GOL572

Appendix to Analytical Report

Customer Contact:

Analysis: US EPA 600, R93-116

This appendix seeks to promote greater understanding of any observations, exceptions, special instructions, or circumstances that the laboratory needs to communicate to the client concerning the above samples. The information below is used to help promote your ability to make the most informed decisions for you and your customers. Please note the following points of contact for any questions you may have.

iATL Customer Service: customerservice@iatl.com

iATL Office Manager: cdavis@iatl.com

iATL Account Representative: Pete Lesniak

Sample Login Notes: See Batch Sheet Attached

Sample Matrix: Bulk Building Materials

Exceptions Noted: See Following Pages

General Terms, Warrants, Limits, Qualifiers:

General information about iATL capabilities and client/laboratory relationships and responsibilities are spelled out in iATL policies that are listed at www.iATL.com and in our Quality Assurance Manual per ISO 17025 standard requirements. The information therein is a representation of iATL definitions and policies for turnaround times, sample submittal, collection media, blank definitions, quantification issues and limit of detection, analytical methods and procedures, sub-contracting policies, results reporting options, fees, terms, and discounts, confidentiality, sample archival and disposal, and data interpretation.

iATL warrants the test results to be of a precision normal for the type and methodology employed for each sample submitted. iATL disclaims any other warrants, expressed or implied, including warranty of fitness for a particular purpose and warranty of merchantability. iATL accepts no legal responsibility for the purpose for which the client uses test results. Any analytical work performed must be governed by our Standard Terms and Conditions. Prices, methods and detection limits may be changed without notification. Please contact your Customer Service Representative for the most current information.

This confidential report relates only to those item(s) tested and does not represent an endorsement by NIST-NVLAP, AIHA LAP LLC, or any agency of local, state or province governments nor of any agency of the U.S. government.

This report shall not be reproduced except in full, without written approval of the laboratory.

Information Pertinent to this Report:

Analysis by US EPA 600 93-116: Determination of Asbestos in Bulk Building Materials by Polarized Light Microscopy (PLM).

Certifications:

- NIST-NVLAP No. 101165-0
- NY-DOH No. 11021
- AIHA-LAP, LLC No. 100188

Quantification at <0.25% by volume is possible with this method. (PC) Indicates Stratified Point Count Method performed. (PC-Trace) means that asbestos was detected but is not quantifiable under the Point Counting regimen. Analysis includes all distinct separable layers in accordance with EPA 600 Method. If not reported or otherwise noted, layer is either not present or the client has specifically requested that it not be analyzed (ex. analyze until positive instructions). Small asbestos fibers may be missed by PLM due to resolution limitations of the optical microscope. Therefore, PLM is not consistently reliable in detecting asbestos in non-friable organically bound (NOB) materials. Quantitative transmission electron microscopy (TEM) is currently the only method that can pronounce materials as non-asbestos containing.

Analytical Methodology Alternatives: Your initial request for analysis may not have accounted for recent advances in regulatory requirements or advances in technology that are routinely used in similar situations for other qualified projects. You may have the option to explore additional analysis for further information. Below are a few options, listed as the matrix followed by the appropriate methodology. Also included are links to more information on our website.

Bulk Building Materials that are Non-Friable Organically Bound (NOB) by Gravimetric Reduction techniques employing PLM and TEM: ELAP 198.6 (PLM-NOB), ELAP 198.4 (TEM-NOB)

Loose Fill Vermiculite Insulation, Attic Insulation, Zonolite (copyright), etc.: US EPA 600 R-4/004 (multi-tiered analytical process)
Sprayed On Insulation/Fireproofing with Vermiculite (SOF-V): ELAP 198.8 (PLM-SOF-V)>

CERTIFICATE OF ANALYSIS

Client: Golder Associates Ltd
16820 107 Ave
Edmonton AB T5P 4C3

Report Date: 10/31/2017
Report No.: 550354 - PLM
Project: City of Saskatoon: Supernatant Valve
Station
Project No.: 1667963

Client: GOL572

Soil, sludge, sediment, aggregate, and like materials analyzed for asbestos or other elongated mineral particles (ex. erionite, etc.): ASTM D7521, CARB 435, and other options available

Asbestos in Surface Dust according to one of ASTM's Methods (very dependent on sampling collection technique – by TEM): ASTM D 5755, D5756, or D6480

Various other asbestos matrices (air, water, etc.) and analytical methods are available.

Disclaimers / Qualifiers:

There may be some samples in this project that have a "NOTE:" associated with a sample result. We use added disclaimers or qualifiers to inform the client about something that requires further explanation. Here is a list with highlighted disclaimers that may be pertinent to this project. For a full explanation of these and other disclaimers, please inquire at customerservice@iatl.com.

- 1) Note: No mastic provided for analysis.
- 2) Note: Insufficient mastic provided for analysis.
- 3) Note: Insufficient material provided for analysis.
- 4) Note: Insufficient sample provided for QC reanalysis.
- 5) Note: Different material than indicated on Sample Log / Description.
- 6) Note: Sample not submitted.
- 7) Note: Attached to asbestos containing material.
- 8) Note: Received wet.
- 9) Note: Possible surface contamination.
- 10) Note: Not building material. 1% threshold may not apply.
- 11) Note: Recommend TEM-NOB analysis as per EPA recommendations.
- 12) Note: Asbestos detected but not quantifiable.
- 13) Note: Multiple identical samples submitted, only one analyzed.
- 14) Note: Analyzed by EPA 600/R-93/116. Point Counting detection limit at 0.080%.
- 15) Note: Analyzed by EPA 600/R-93/116. Point Counting detection limit at 0.125%.

Recommendations for Vermiculite Analysis:

Several analytical protocols exist for the analysis of asbestos in vermiculite. These analytical approaches vary depending upon the nature of the vermiculite mineral being tested (e.g. un-processed gange, homogeneous exfoliated books of mica, or mixed mineral composites). Please contact your client representative for pricing and turnaround time options available.

iATL recommends initial testing using the EPA 600/R-93/116 method. This method is specifically designed for the analysis of asbestos in bulk building materials. It provides an acceptable starting point for primary screening of vermiculite for possible asbestos.

Results from this testing may be inconclusive. EPA suggests proceeding to a multi-tiered analysis involving wet separation techniques in conjunction with PLM and TEM gravimetric analysis (EPA 600/R-04/004).

Further information on this method and other vermiculite and asbestos issues can be found at the following: Agency for Toxic Substances and Disease Registry (ATSDR) www.atsdr.cdc.gov, United States Geological Survey (USGS) www.minerals.usgs.gov/minerals/, US EPA www.epa.gov/asbestos. The USEPA also has an informative brochure "Current Best Practices for Vermiculite Attic Insulation" EPA 747F03001 May 2003, that may assist the health and remediation professional.

The following is a summary of the analytical process outlines in the EPA 600/R-04/004 Method:

- 1) **Analytical Step/Method:** Initial Screening by PLM, EPA 600R-93/116
Requirements/Comments: Minimum of 0.1 g of sample. ~0.25% LOQ for most samples.
- 2) **Analytical Step/Method:** Wet Separation by PLM Gravimetric Technique, EPA R-04/004
Requirements/Comments: Minimum 50g** of dry sample. Analysis of "Sinks" only.
- 3) **Analytical Step/Method:** Wet Separation by PLM Gravimetric Technique, EPA R-04/004
Requirements/Comments: Minimum 50g** of dry sample. Analysis of "Floats" only.
- 4) **Analytical Step/Method:** Wet Separation by TEM Gravimetric Technique, EPA R-04/004
Requirements/Comments: Minimum 50g** of dry sample. Analysis of "Sinks" only.
- 5) **Analytical Step/Method:** Wet Separation by TEM Gravimetric Technique, EPA R-04/004

CERTIFICATE OF ANALYSIS

Client: Golder Associates Ltd
16820 107 Ave
Edmonton AB T5P 4C3

Report Date: 10/31/2017
Report No.: 550354 - PLM
Project: City of Saskatoon: Supernatant Valve
Station
Project No.: 1667963

Client: GOL572

Requirements/Comments: Minimum 50g** of dry sample. Analysis of "Suspension" only.

LOQ, Limit of Quantitation estimates for mass and volume analyses.

*With advance notice and confirmation by the laboratory.

**Approximately 1 Liter of sample in double-bagged container (~9x6 inch bag of sample).



APPENDIX B

Supernatant Valve Chamber – ACM Inventory

Appendix B
Supernatant Valve Chamber
ACM Inventory

Included/Excluded	Floor	Room #	Area Description	Elements	Subelements	Material Description	Accessibility	Suspect?	Sampled?	Asbestos Containing Material?	Condition	Field Notes	Sample Type	Sample ID	Sample Date	Asbestos Type	ACM Product	% of asbestos	Friable	Sprayed-on	Maintenance	Inspection	Priority	Potential for Disturbance	Recommended Action	Quantity	Photograph ID	Labelling Type
Included	M	Main	Open Area	Door	Regular Door	Non Suspect Door	High	No	No	No	Good	Non-suspect door was observed at the Site.																
Included	M	Main	Open Area	Walls	Walls	Plastic Panelling	High	No	No	No	Good																	
Included	M	Main	Open Area	Floor	Floor	Concrete	High	No	No	No	Good																	
Included	M	Main	Open Area	Ceiling	Ceiling	Wood	High	No	No	No	Good																	
Included	M	Main	Open Area	Miscellaneous	Caulking	White Caulking	High	No	Yes	No	Good	On window frames.	Bulk	A-001	18-Oct-17													
Included	M	Main	Attic Space	Insulation	Insulation	Fibreglass	Moderate	No	No	No	Good	Loose-fill vermiculite not observed below fibreglass. However, attic was not fully entered during the assessment.																
Included	L	Lower	Open Area	Walls	Walls	Concrete	High	No	No	No	Good																	
Included	L	Lower	Open Area	Floor	Floor	Concrete	High	No	No	No	Good																	
Included	L	Lower	Open Area	Ceiling	Ceiling	Concrete	High	No	No	No	Good																	
Included	L	Lower	Open Area	Mechanical	Piping	Metal Pipes	High	No	No	No	Good	Bare or insulated with fibreglass and PVC fittings.																
Included	L	Lower	Open Area	Electrical	Electrical Panels and Components	Electrical Panels and Components	High	Yes	No	Potential	Good	Not sampled due to safety concerns.												Inspect and sample if scheduled for removal.				
Included	E	Exterior	Exterior	Walls	Walls	Metal	High	No	No	No	Good																	
Included	E	Exterior	Exterior	Miscellaneous	Firestop	Grey firestop	High	No	Yes	No	Good		Bulk	A-002	18-Oct-17													
Included	E	Exterior	Exterior	Miscellaneous	Caulking	White Caulking	High	No	Yes	No	Good	On door frame.	Bulk	A-003	18-Oct-17													
Excluded	E	Exterior	Roof	Exterior Roof	Exterior Roof							Not assessed due to scope of work.																



APPENDIX C

Floor Plan

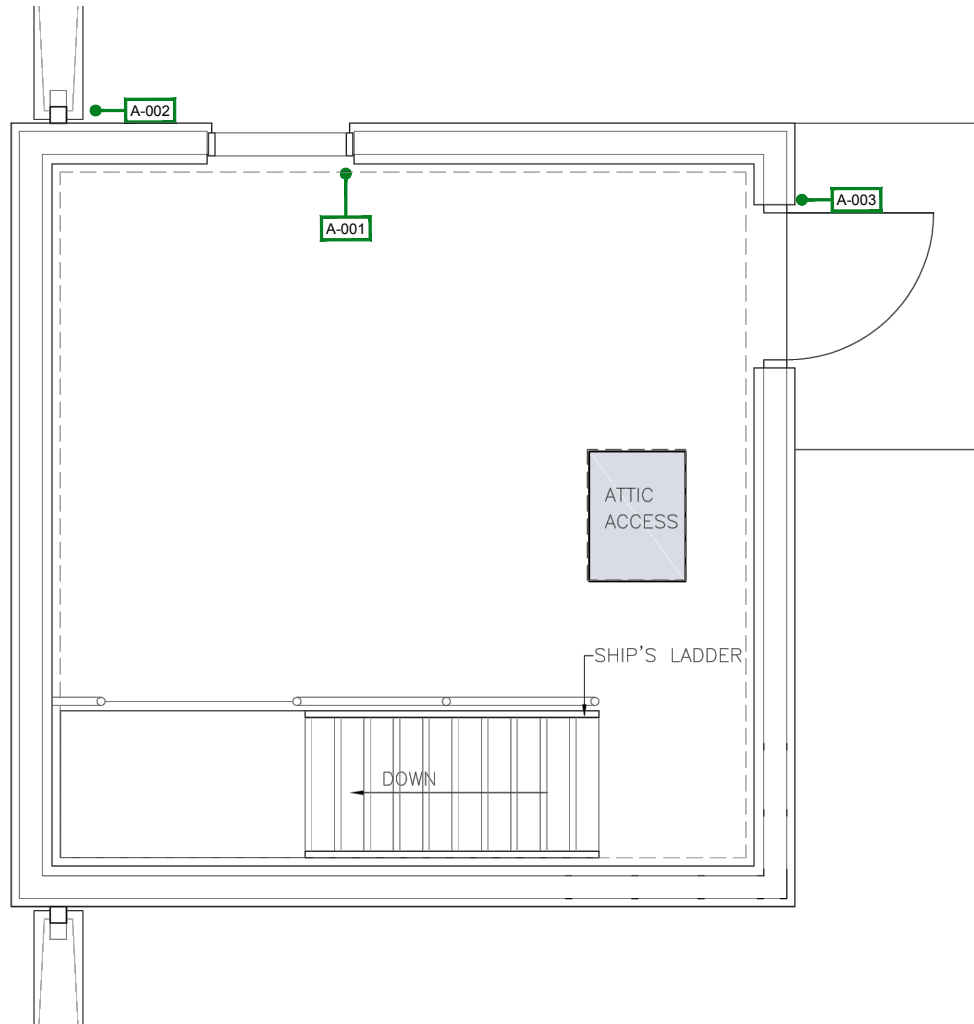

- LEGEND**
- ASBESTOS SAMPLE LOCATION
 - NO ACCESS

- NOTE(S)**
1. ASBESTOS IS A CARCINOGEN. DO NOT BREATHE ASBESTOS DUST.
 2. ASBESTOS-CONTAINING MATERIALS WERE NOT OBSERVED ON SITE DURING THE ASSESSMENT.

REFERENCE(S)
 PLAN OBTAINED FROM INFRASTRUCTURE SERVICES DEPARTMENT CITY OF SASKATOON. DATED: 18/11/2016

CLIENT
 CITY OF SASKATOON

CONSULTANT



YYYY-MM-DD 2017-11-23

DESIGNED KH

PREPARED VI

REVIEWED KH

APPROVED AG

SCHEMATIC ONLY, NOT TO SCALE



PROJECT
**ASBESTOS ASSESSMENT
 SUPERNATANT VALVE CHAMBER**

TITLE
MAIN FLOOR

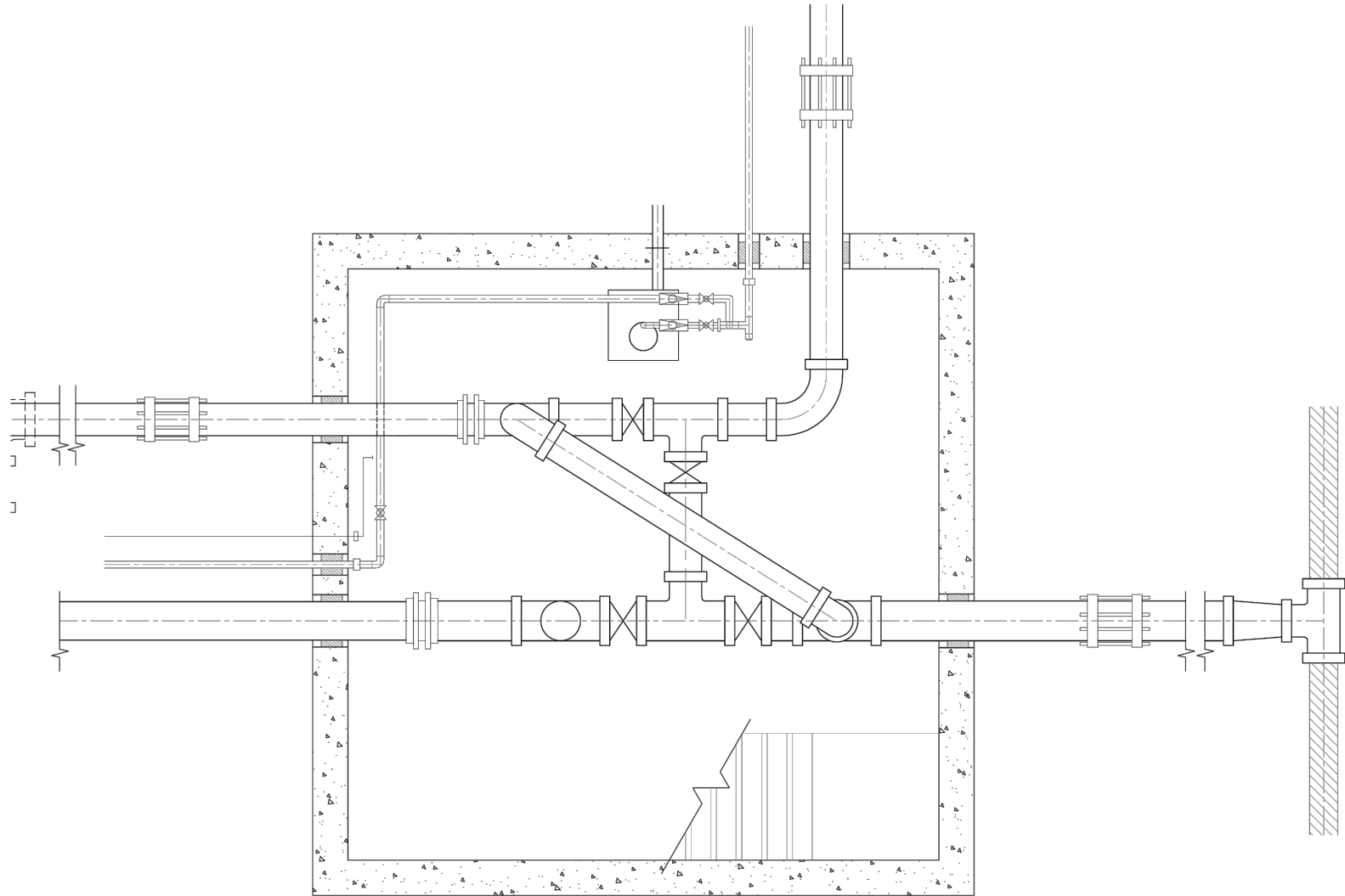
PROJECT NO. 1667963	CONTROL 1000-HM-0001	REV. 0	FIGURE 1
------------------------	-------------------------	-----------	-------------



LEGEND

-  ASBESTOS SAMPLE LOCATION
-  NO ACCESS

NOTE(S)

1. ASBESTOS IS A CARCINOGEN. DO NOT BREATHE ASBESTOS DUST.
2. ASBESTOS-CONTAINING MATERIALS WERE NOT OBSERVED ON SITE DURING THE ASSESSMENT.

REFERENCE(S)

PLAN OBTAINED FROM INFRASTRUCTURE SERVICES DEPARTMENT CITY OF SASKATOON. DATED: 18/11/2016

CLIENT
 CITY OF SASKATOON

CONSULTANT



YYYY-MM-DD 2017-11-23

DESIGNED KH

PREPARED VI

REVIEWED KH

APPROVED AG

SCHEMATIC ONLY, NOT TO SCALE

PROJECT

ASBESTOS ASSESSMENT
 SUPERNATANT VALVE CHAMBER

TITLE

MAIN FLOOR

PROJECT NO.
 1667963

CONTROL
 1000-HM-0002

REV.
 0

FIGURE
 2

IF THIS MEASUREMENT DOES NOT MATCH WHAT IS SHOWN, THE SHEET SIZE HAS BEEN MODIFIED FROM: ANSI A

26 mm

As a global, employee-owned organisation with over 50 years of experience, Golder Associates is driven by our purpose to engineer earth's development while preserving earth's integrity. We deliver solutions that help our clients achieve their sustainable development goals by providing a wide range of independent consulting, design and construction services in our specialist areas of earth, environment and energy.

For more information, visit golder.com

Africa	+ 27 11 254 4800
Asia	+ 86 21 6258 5522
Australasia	+ 61 3 8862 3500
Europe	+ 356 21 42 30 20
North America	+ 1 800 275 3281
South America	+ 56 2 2616 2000

solutions@golder.com
www.golder.com

Golder Associates Ltd.
16820 107 Avenue
Edmonton, Alberta, T5P 4C3
Canada
T: +1 (780) 483 3499

