

Adelaide Lift Station

Sample Number	Sample Description	Sample Location
A-001	White Caulking	Interior of Lift Station
A-002	Rope Gasket	Interior of Lift Station
A-003	Grey Firestop Putty	Interior of Lift Station
A-004	White Caulking	Exterior
A-005	Grey Caulking	Exterior



City of
Saskatoon

Asset & Financial
Management

Facilities & Fleet
306-976-3300

NOTE:
THESE DRAWINGS HAVE BEEN PREPARED
BASED ON INFORMATION PROVIDED BY
OTHERS. THE CITY HAS TAKEN STEPS
TO VERIFY THE ACCURACY AND/OR
COMPLETENESS OF THIS INFORMATION
BUT SHALL NOT BE RESPONSIBLE FOR
AND ERRORS OR OMISSIONS THAT
MAY BE INCORPORATED AS A RESULT
OF ENRICHED INFORMATION PROVIDED
BY OTHERS THAT WAS NOT ABLE TO BE
VISUALLY CONFIRMED.

GENERAL NOTES:
1. ALL DIMENSIONS ARE IN MILLIMETRES
2. DRAWINGS ARE NOT TO BE SCALED
3. ALL DRAWINGS TO BE READ IN CON-
JUNCTION WITH THE SPECIFICATIONS
UNLESS OTHERWISE NOTED
4. VERIFY SITE CONDITIONS, DIMENSIONS
AND LOCATION OF ALL UTILITIES PRIOR
TO THE START OF CONSTRUCTION
5. REPORT ALL DISCREPANCIES TO THE
CONSULTANT

 Asbestos-containing
caulking and
rope gasket

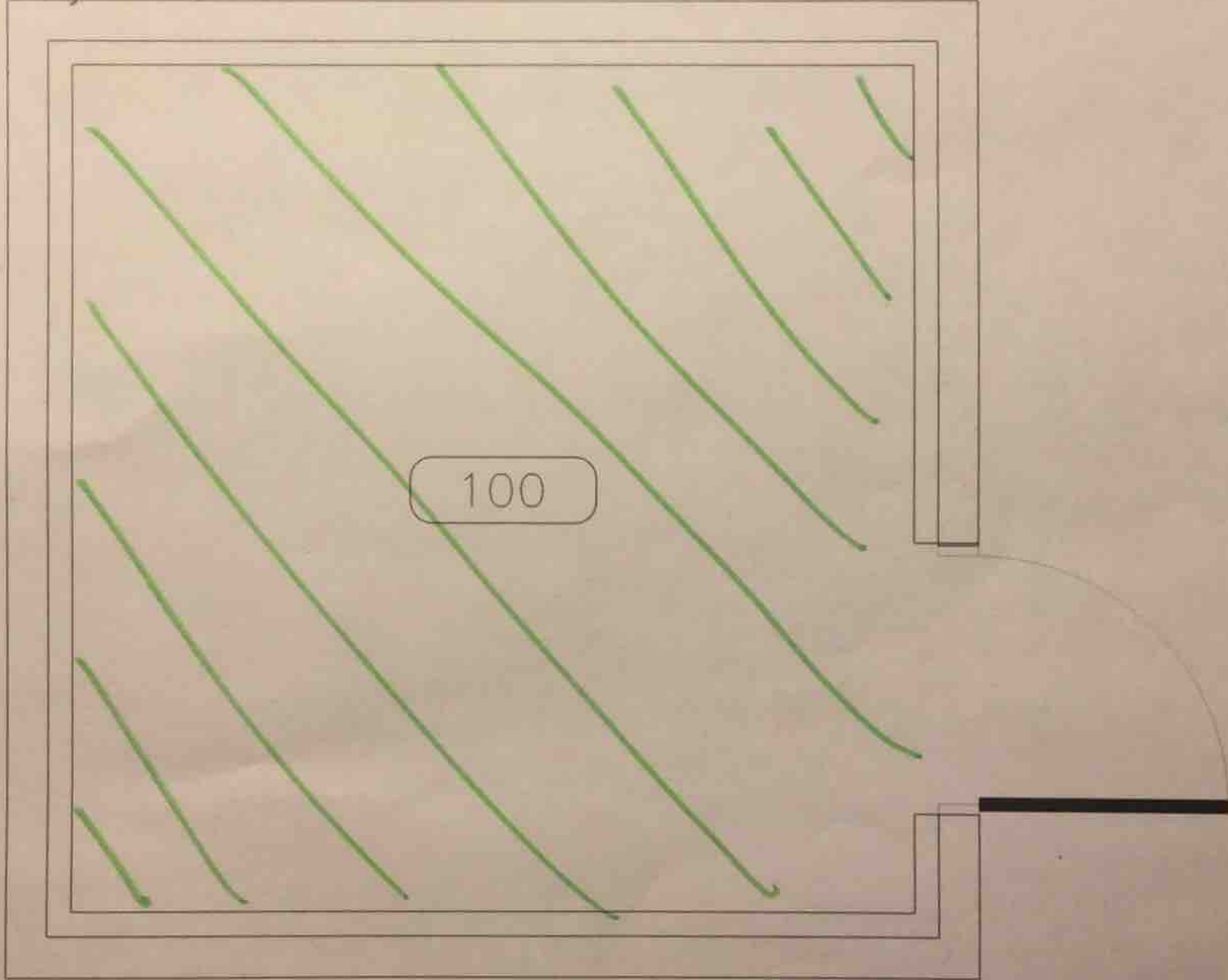

Notes:
1) Asbestos is a carcinogen. Do not inhale dust.
2) Asbestos-containing caulking is present on the exterior

REV ISSUED FOR DATE

DRAWN BY: [] CHECKED BY: []
DATE: []

SCALE: 1:20 DATE: 24/10/2016

SHEET NAME:
Main Floor
Floor Plan

PROJECT TITLE:
676
Adelaide Park
Lift Station

PROJECT NO. SHEET NO. REV. NO.