



December 5, 2017

CITY OF SASKATOON

Asbestos-Containing Building Materials Assessment Report - Waste Water Grit Tanks Building



REPORT

Submitted to:

The City of Saskatoon
1101 Avenue P North
Saskatoon, SK S7L 7K6

Report Number: 1667963

Distribution:

One Copy: City of Saskatoon
One Copy: Golder Associates Ltd.





Table of Contents

1.0 INTRODUCTION.....	1
2.0 SCOPE OF WORK	1
2.1 Asbestos-Containing Materials	1
3.0 RESULTS AND DISCUSSION	2
3.1 Asbestos-Containing Materials	2
3.1.1 Non Asbestos-Containing Materials	2
4.0 EXCLUDED AREAS AND MATERIALS	3
5.0 CONCLUSIONS AND RECOMMENDATIONS.....	3
5.1 Asbestos-Containing Materials	3
6.0 SURVEY LIMITATIONS.....	3
7.0 CLOSURE.....	4

APPENDICES

APPENDIX A

Laboratory Certificate of Analysis

APPENDIX B

Waste Water Grit Tanks Building – ACM Inventory

APPENDIX C

Floor Plans



1.0 INTRODUCTION

Golder Associates Ltd. (Golder) was retained by the City of Saskatoon (the Client) to conduct an asbestos-containing building materials assessment of the Waste Water Grit Tanks Building (the Site) located at 470 Whiteswan Drive in Saskatoon, Saskatchewan. This assessment report details our findings, conclusions and recommendations for the Site. A walkthrough of the Site was conducted on June 22, 2017 by Kody Henderson, OHS Project Manager, and the assessment was conducted on October 12, 2017 by Scott Bishop, Junior Occupational Hygienist. Asbestos-containing building materials were not identified within the Waste Water Grit Tanks Building during the assessment. Further information is provided in Section 3.0.

2.0 SCOPE OF WORK

In accordance with Tender 16-0844, Golder's scope of work included conducting an asbestos-containing building materials assessment of the Site to evaluate the quantities, locations, and conditions of asbestos-containing building materials.

Following the field work, Golder prepared this assessment report that includes laboratory analysis results, findings of the assessment, conclusions, and recommendations.

2.1 Asbestos-Containing Materials

The assessment involved a non-destructive inspection of the Site to assess the type and extent of suspect ACMs in the facility. The systems that were reviewed as part of the inspections included, but were not limited to:

- *Structural* - systems including: insulation between solid webbed joists, fireproofing, building envelope, and interior/exterior caulking around windows and doors;
- *Mechanical* - systems insulation including: hot water and steam system, condensate system, chilled water system, glycol system, domestic hot and cold water, emergency generator exhaust, boiler units, heat exchangers, and asbestos cement piping; and
- *Architectural* - systems including: texture coats, sheet flooring, vinyl floor tile, acoustical spray-applied materials, condensation control applications, ceiling tile, wall board, drywall joint compound, and asbestos sheet products.

Systematic sampling of suspect ACMs was conducted as part of the assessment. Samples were submitted under chain of custody to International Asbestos Testing Laboratory Inc. (IATL) and analyzed for asbestos type and percentage content using Polarized Light Microscopy (PLM) in accordance with EPA methodologies (EPA 600/R-93/116).

Further information related to the assessment and sample collection methods can be found in the Golder document *Golder Asbestos Assessment General Survey Plan and Protocol* provided to the Client.



3.0 RESULTS AND DISCUSSION

The Waste Water Grit Tanks Building consists of open equipment rooms, a washroom and an MCC Room, and was constructed in 1971. During the assessment, the entire building was treated as one functional space.

- The Laboratory Certificate of Analysis report for the bulk asbestos samples is included in Appendix A.
- A room by room spreadsheet outlining the locations, quantities, friability, and condition of identified asbestos-containing materials as well as additional information is provided in Appendix B.
- A floor plan is provided in Appendix C.
- Please refer to Sections 4.0 and 6.0 of this report for a summary of the limitations encountered.

3.1 Asbestos-Containing Materials

A total of twenty-one (21) samples of building materials were collected and tested for asbestos content during the assessment of the Waste Water Grit Tanks Building. None of the samples were found to contain asbestos.

3.1.1 Non Asbestos-Containing Materials

The following materials were sampled during this assessment and were found to not contain asbestos or were observed to be non-suspect materials:

- Grey building caulking;
- White firestop;
- Brown mastic pucks;
- Red firestop;
- Dark grey duct mastic;
- Light grey duct mastic;
- Grey window caulking;
- Exterior light grey firestop putty;
- Exterior grey window caulking;
- Exterior grey expansion joint caulking;
- Exterior white caulking on cladded piping;
- Exterior silver caulking on cladded piping;
- Exterior grey caulking on concrete;
- Exterior brick mortar;
- Black mastic on fibreglass; and,
- White building caulking.



No further suspect asbestos-containing materials were observed during the assessment. The building was generally observed to have concrete floors and ceilings with cinderblock and concrete walls.

4.0 EXCLUDED AREAS AND MATERIALS

The following is a list of the areas and/or materials excluded during the assessment.

- Building materials accessible by a ten foot ladder were assessed by Golder during the assessment. Materials located at heights that were inaccessible from a ten foot ladder were not assessed. If materials at heights are to be removed or impacted by future renovation or demolition activities, additional investigation and sampling of suspect materials may be required.
- The roof and associated components were not assessed by Golder during the assessment as per Tender 16-0844. If the roof and associated components are to be removed or impacted by future renovation or demolition activities, additional investigation and sampling of suspect materials may be required.
- Electrical components were not assessed by Golder during the assessment as per Tender 16-0844. If the electrical components are to be removed or impacted by future renovation or demolition activities, additional investigation and sampling of suspect materials may be required.
- The fire doors were not assessed by Golder during the assessment. If the fire doors are to be removed or impacted by future renovation or demolition activities, additional coring, investigation and sampling of suspect materials may be required.

5.0 CONCLUSIONS AND RECOMMENDATIONS

Based on the visual assessment, the following project specific conclusions and recommendations are provided.

5.1 Asbestos-Containing Materials

No suspect asbestos-containing materials were observed within the Waste Water Grit Tanks Building.

If suspect asbestos-containing building materials are encountered during renovation or demolition activities, sampling should be undertaken to evaluate asbestos content.

6.0 SURVEY LIMITATIONS

This report is based on data and information collected by Golder during the assessment conducted on October 12, 2017 and is based solely on site conditions encountered at the time of the assessment. Any use of this document or the findings, conclusions or recommendations provided in this report by any person other than the City of Saskatoon is at the sole risk of such user.

The conclusions and recommendations contained in this survey report are based upon professional opinions with regard to the subject matter. These opinions are in accordance with currently accepted environmental assessment standards and practices applicable to these locations and are subject to the following inherent limitations:

The data and findings presented in this report are valid as of the dates of the investigations. The passage of time, manifestation of latent conditions or occurrence of future events may warrant further exploration at the properties, analysis of the data, and re-evaluation of the findings, observations, and conclusions expressed in this report. No assurance is made regarding changes in conditions or practices subsequent to the time of the investigation. It was beyond the scope of this assessment to conduct a risk assessment and the potential health risks that may be associated with asbestos exposure for building occupants.



ASBESTOS-CONTAINING BUILDING MATERIALS ASSESSMENT REPORT - WASTE WATER GRIT TANKS BUILDING

The data reported and the findings, observations and conclusions expressed in this report are limited by the Scope of Work. The Scope of Work was defined by Tender 16-0844 and the initial site walkthrough with the Client, the time and budgetary constraints imposed by the Client, and availability of access to the property.

Because of the limitations stated above, the findings, observations and conclusions expressed by Golder in this report are not, and must not be, considered an opinion concerning compliance of any past or present owner or operator of the site with any federal, provincial or local laws or regulations.

No warranty or guarantee, whether expressed or implied, is made with respect to the data or the reported findings, observations, and conclusions, which are based solely upon site conditions in existence at the time of investigation.

Golder's assessment reports present professional opinions and findings of a scientific and technical nature. While attempts were made to relate the data and findings to applicable environmental laws and regulations, the report shall not be construed to offer legal opinion or representations as to the requirements of, nor compliance with, environmental laws, rules, regulations or policies of federal, provincial, or local governmental agencies. Any use of the survey report constitutes acceptance of the limits of Golder's liability.

Golder's liability extends only to its client and not to other parties who may obtain this survey report. Issues raised by the report must be reviewed by appropriate legal counsel.

7.0 CLOSURE

We trust the information presented in this report meets your requirements. If you have any questions, please contact Kody Henderson at (780) 483-3499 or email at kody_henderson@golder.com. Thank you for the opportunity to be of service. We look forward to working with you again in the future.



ASBESTOS-CONTAINING BUILDING MATERIALS ASSESSMENT REPORT - WASTE WATER GRIT TANKS BUILDING

Report Signature Page

GOLDER ASSOCIATES LTD.

Prepared by:

Scott Bishop, B.A.
Junior Occupational Hygienist

Reviewed by:

Andrew Grant, B.Sc., P.Eng., EP, CRSP
Associate, OHS Project Director

SWB/KH/AG/ba

Golder, Golder Associates and the GA globe design are trademarks of Golder Associates Corporation.

\\golder\galliedmonton\active\2016\3 proj\1667963 cityofsaskatoon_asbsurveys_saskatoon\07 reports\57 - wastewater grit tank\city of saskatoon - waste water grit building - asbestos building material assessment report.docx



APPENDIX A

Laboratory Certificate of Analysis

CERTIFICATE OF ANALYSIS

Client: Golder Associates Ltd
16820 107 Ave
Edmonton AB T5P 4C3

Client: GOL572

Report Date: 10/27/2017
Report No.: 550052 - PLM
Project: Grit Building
Project No.: 1667963

PLM BULK SAMPLE ANALYSIS SUMMARY

Lab No.: 6368224 Client No.: A-001	Analyst Observation: Grey Caulk Client Description: Grey Caulking	Location: C103 Facility:
<u>Percent Asbestos:</u> <i>None Detected</i>	<u>Percent Non-Asbestos Fibrous Material:</u> 2 Cellulose	<u>Percent Non-Fibrous Material:</u> 98
Lab No.: 6368225 Client No.: A-002	Analyst Observation: Yellow/Off-White Caulk Client Description: White Firestop	Location: C103 Facility:
<u>Percent Asbestos:</u> <i>None Detected</i>	<u>Percent Non-Asbestos Fibrous Material:</u> 2 Cellulose	<u>Percent Non-Fibrous Material:</u> 98
Lab No.: 6368226 Client No.: A-003	Analyst Observation: Brown Mastic Client Description: Brown Mastic Pucks	Location: C101 Facility:
<u>Percent Asbestos:</u> <i>None Detected</i>	<u>Percent Non-Asbestos Fibrous Material:</u> 1 Cellulose	<u>Percent Non-Fibrous Material:</u> 99
Lab No.: 6368226(L2) Client No.: A-003	Analyst Observation: White Fibrous Client Description: Brown Mastic Pucks	Location: C101 Facility:
<u>Percent Asbestos:</u> <i>None Detected</i>	<u>Percent Non-Asbestos Fibrous Material:</u> 50 Cellulose 10 Fibrous Glass	<u>Percent Non-Fibrous Material:</u> 40
Lab No.: 6368227 Client No.: A-004	Analyst Observation: Red Caulk Client Description: Red Firestop	Location: C101 Facility:
<u>Percent Asbestos:</u> <i>None Detected</i>	<u>Percent Non-Asbestos Fibrous Material:</u> 1 Cellulose	<u>Percent Non-Fibrous Material:</u> 99
Lab No.: 6368228 Client No.: A-005	Analyst Observation: Grey Caulk Client Description: Dk Grey Duct Mastic	Location: C101 Facility:
<u>Percent Asbestos:</u> <i>None Detected</i>	<u>Percent Non-Asbestos Fibrous Material:</u> 2 Cellulose	<u>Percent Non-Fibrous Material:</u> 98

Analytical Method -US EPA 600, R93-116. Please refer to the Appendix of this report for further information regarding your analysis.

Date Received: 10/18/2017
Date Analyzed: 10/27/2017
Signature: 
Analyst: Jyotika Shah

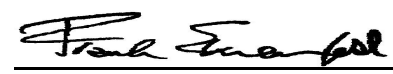
Approved By: 
Frank E. Ehrenfeld, III
Laboratory Director

CERTIFICATE OF ANALYSIS

Client: Golder Associates Ltd
16820 107 Ave
Edmonton AB T5P 4C3

Report Date: 10/27/2017
Report No.: 550052 - PLM
Project: Grit Building
Project No.: 1667963

Client: GOL572

PLM BULK SAMPLE ANALYSIS SUMMARY

Lab No.: 6368229 Client No.: A-006 <u>Percent Asbestos:</u> <i>None Detected</i>	Analyst Observation: Grey Caulk Client Description: Lt Grey Duct Mastic <u>Percent Non-Asbestos Fibrous Material:</u> 3 Cellulose	Location: C101 Facility: <u>Percent Non-Fibrous Material:</u> 97
Lab No.: 6368230 Client No.: A-007 <u>Percent Asbestos:</u> <i>None Detected</i>	Analyst Observation: Grey Caulk Client Description: Grey Window Caulking <u>Percent Non-Asbestos Fibrous Material:</u> 2 Cellulose	Location: 100 Facility: <u>Percent Non-Fibrous Material:</u> 98
Lab No.: 6368231 Client No.: A-008 <u>Percent Asbestos:</u> <i>None Detected</i>	Analyst Observation: Grey Caulk Client Description: Lt Grey Putty On Electrical Box <u>Percent Non-Asbestos Fibrous Material:</u> 2 Cellulose	Location: Exterior Facility: <u>Percent Non-Fibrous Material:</u> 98
Lab No.: 6368232 Client No.: A-009 <u>Percent Asbestos:</u> <i>None Detected</i>	Analyst Observation: Grey Caulk Client Description: Grey Window Caulking <u>Percent Non-Asbestos Fibrous Material:</u> 3 Cellulose	Location: Exterior Facility: <u>Percent Non-Fibrous Material:</u> 97
Lab No.: 6368233 Client No.: A-010 <u>Percent Asbestos:</u> <i>None Detected</i>	Analyst Observation: Grey Caulk Client Description: Grey Expansion Joint Caulking <u>Percent Non-Asbestos Fibrous Material:</u> 1 Cellulose	Location: Exterior Facility: <u>Percent Non-Fibrous Material:</u> 99
Lab No.: 6368234 Client No.: A-011 <u>Percent Asbestos:</u> <i>None Detected</i>	Analyst Observation: White Caulk Client Description: White Caulking On Piping <u>Percent Non-Asbestos Fibrous Material:</u> 2 Cellulose	Location: Exterior Facility: <u>Percent Non-Fibrous Material:</u> 98

Analytical Method -US EPA 600, R93-116. Please refer to the Appendix of this report for further information regarding your analysis.

Date Received: 10/18/2017
Date Analyzed: 10/27/2017
Signature: 
Analyst: Jyotika Shah

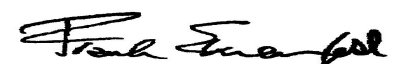
Approved By: 
Frank E. Ehrenfeld, III
Laboratory Director

CERTIFICATE OF ANALYSIS

Client: Golder Associates Ltd
16820 107 Ave
Edmonton AB T5P 4C3

Report Date: 10/27/2017
Report No.: 550052 - PLM
Project: Grit Building
Project No.: 1667963

Client: GOL572

PLM BULK SAMPLE ANALYSIS SUMMARY

Lab No.: 6368235
Client No.: A-012
Analyst Observation: Off-White Mortar
Client Description: Brick Mortar
Location: Exterior
Facility:
Percent Asbestos:
None Detected
Percent Non-Asbestos Fibrous Material:
None Detected
Percent Non-Fibrous Material:
100

Lab No.: 6368235(L2)
Client No.: A-012
Analyst Observation: Off-White Cementitious
Client Description: Brick Mortar
Location: Exterior
Facility:
Percent Asbestos:
None Detected
Percent Non-Asbestos Fibrous Material:
None Detected
Percent Non-Fibrous Material:
100

Lab No.: 6368236
Client No.: A-013
Analyst Observation: Off-White Mortar
Client Description: Brick Mortar
Location: Exterior
Facility:
Percent Asbestos:
None Detected
Percent Non-Asbestos Fibrous Material:
None Detected
Percent Non-Fibrous Material:
100

Lab No.: 6368236(L2)
Client No.: A-013
Analyst Observation: Off-White Cementitious
Client Description: Brick Mortar
Location: Exterior
Facility:
Percent Asbestos:
None Detected
Percent Non-Asbestos Fibrous Material:
None Detected
Percent Non-Fibrous Material:
100

Lab No.: 6368237
Client No.: A-014
Analyst Observation: Off-White Mortar
Client Description: Brick Mortar
Location: Exterior
Facility:
Percent Asbestos:
None Detected
Percent Non-Asbestos Fibrous Material:
None Detected
Percent Non-Fibrous Material:
100

Lab No.: 6368238
Client No.: A-015
Analyst Observation: Off-White Mortar
Client Description: Brick Mortar
Location: Exterior
Facility:
Percent Asbestos:
None Detected
Percent Non-Asbestos Fibrous Material:
None Detected
Percent Non-Fibrous Material:
100

Analytical Method -US EPA 600, R93-116. Please refer to the Appendix of this report for further information regarding your analysis.

Date Received: 10/18/2017
Date Analyzed: 10/27/2017
Signature: 
Analyst: Jyotika Shah

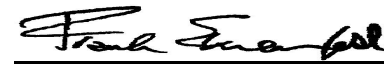
Approved By: 
Frank E. Ehrenfeld, III
Laboratory Director

CERTIFICATE OF ANALYSIS

Client: Golder Associates Ltd
16820 107 Ave
Edmonton AB T5P 4C3

Report Date: 10/27/2017
Report No.: 550052 - PLM
Project: Grit Building
Project No.: 1667963

Client: GOL572

PLM BULK SAMPLE ANALYSIS SUMMARY

Lab No.: 6368239 Client No.: A-016 <u>Percent Asbestos:</u> <i>None Detected</i>	Analyst Observation: Off-White Mortar Client Description: Brick Mortar <u>Percent Non-Asbestos Fibrous Material:</u> None Detected	Location: Exterior Facility: <u>Percent Non-Fibrous Material:</u> 100
Lab No.: 6368240 Client No.: A-017 <u>Percent Asbestos:</u> <i>None Detected</i>	Analyst Observation: Grey Caulk Client Description: Silver Caulking On Piping <u>Percent Non-Asbestos Fibrous Material:</u> 2 Cellulose	Location: Exterior Facility: <u>Percent Non-Fibrous Material:</u> 98
Lab No.: 6368241 Client No.: A-018 <u>Percent Asbestos:</u> <i>None Detected</i>	Analyst Observation: Grey Caulk Client Description: Grey Caulking On Concrete <u>Percent Non-Asbestos Fibrous Material:</u> 1 Cellulose	Location: Exterior Facility: <u>Percent Non-Fibrous Material:</u> 99
Lab No.: 6368242 Client No.: A-019 <u>Percent Asbestos:</u> <i>None Detected</i>	Analyst Observation: Grey Caulk Client Description: Grey Mastic On Concrete <u>Percent Non-Asbestos Fibrous Material:</u> 1 Cellulose	Location: C100 Facility: <u>Percent Non-Fibrous Material:</u> 99
Lab No.: 6368243 Client No.: A-020 <u>Percent Asbestos:</u> <i>None Detected</i>	Analyst Observation: Black Mastic Client Description: Black Mastic On Fiberglass <u>Percent Non-Asbestos Fibrous Material:</u> 2 Cellulose	Location: C100 Facility: <u>Percent Non-Fibrous Material:</u> 98
Lab No.: 6368243(L2) Client No.: A-020 <u>Percent Asbestos:</u> <i>None Detected</i>	Analyst Observation: Yellow Mastic Client Description: Black Mastic On Fiberglass <u>Percent Non-Asbestos Fibrous Material:</u> 1 Cellulose	Location: C100 Facility: <u>Percent Non-Fibrous Material:</u> 99

Analytical Method -US EPA 600, R93-116. Please refer to the Appendix of this report for further information regarding your analysis.

Date Received: 10/18/2017
Date Analyzed: 10/27/2017
Signature: 
Analyst: Jyotika Shah

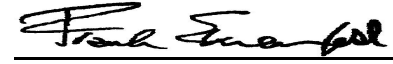
Approved By: 
Frank E. Ehrenfeld, III
Laboratory Director

CERTIFICATE OF ANALYSIS

Client: Golder Associates Ltd
16820 107 Ave
Edmonton AB T5P 4C3

Client: GOL572

Report Date: 10/27/2017
Report No.: 550052 - PLM
Project: Grit Building
Project No.: 1667963

PLM BULK SAMPLE ANALYSIS SUMMARY

Lab No.: 6368244

Client No.: A-021

Percent Asbestos:

None Detected

Analyst Observation: White Caulk

Client Description: White Building Caulking

Percent Non-Asbestos Fibrous Material:

2 Cellulose

Location: 100

Facility:

Percent Non-Fibrous Material:

98

Analytical Method -US EPA 600, R93-116. Please refer to the Appendix of this report for further information regarding your analysis.

Date Received: 10/18/2017

Date Analyzed: 10/27/2017

Signature:

Analyst: Jyotika Shah

Approved By:

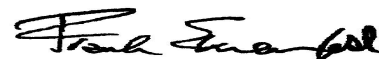

Frank E. Ehrenfeld, III
Laboratory Director

CERTIFICATE OF ANALYSIS

Client: Golder Associates Ltd
16820 107 Ave
Edmonton AB T5P 4C3

Client: GOL572

Report Date: 10/27/2017
Report No.: 550052 - PLM
Project: Grit Building
Project No.: 1667963

Appendix to Analytical Report

Customer Contact:

Analysis: US EPA 600, R93-116

This appendix seeks to promote greater understanding of any observations, exceptions, special instructions, or circumstances that the laboratory needs to communicate to the client concerning the above samples. The information below is used to help promote your ability to make the most informed decisions for you and your customers. Please note the following points of contact for any questions you may have.

iATL Customer Service: customerservice@iatl.com

iATL Office Manager: cdavis@iatl.com

iATL Account Representative: Pete Lesniak

Sample Login Notes: See Batch Sheet Attached

Sample Matrix: Bulk Building Materials

Exceptions Noted: See Following Pages

General Terms, Warrants, Limits, Qualifiers:

General information about iATL capabilities and client/laboratory relationships and responsibilities are spelled out in iATL policies that are listed at www.iATL.com and in our Quality Assurance Manual per ISO 17025 standard requirements. The information therein is a representation of iATL definitions and policies for turnaround times, sample submittal, collection media, blank definitions, quantification issues and limit of detection, analytical methods and procedures, sub-contracting policies, results reporting options, fees, terms, and discounts, confidentiality, sample archival and disposal, and data interpretation.

iATL warrants the test results to be of a precision normal for the type and methodology employed for each sample submitted. iATL disclaims any other warrants, expressed or implied, including warranty of fitness for a particular purpose and warranty of merchantability. iATL accepts no legal responsibility for the purpose for which the client uses test results. Any analytical work performed must be governed by our Standard Terms and Conditions. Prices, methods and detection limits may be changed without notification. Please contact your Customer Service Representative for the most current information.

This confidential report relates only to those item(s) tested and does not represent an endorsement by NIST-NVLAP, AIHA LAP LLC, or any agency of local, state or province governments nor of any agency of the U.S. government.

This report shall not be reproduced except in full, without written approval of the laboratory.

Information Pertinent to this Report:

Analysis by US EPA 600 93-116: Determination of Asbestos in Bulk Building Materials by Polarized Light Microscopy (PLM).

Certifications:

- NIST-NVLAP No. 101165-0
- NY-DOH No. 11021
- AIHA-LAP, LLC No. 100188

Quantification at <0.25% by volume is possible with this method. (PC) Indicates Stratified Point Count Method performed. (PC-Trace) means that asbestos was detected but is not quantifiable under the Point Counting regimen. Analysis includes all distinct separable layers in accordance with EPA 600 Method. If not reported or otherwise noted, layer is either not present or the client has specifically requested that it not be analyzed (ex. analyze until positive instructions). Small asbestos fibers may be missed by PLM due to resolution limitations of the optical microscope. Therefore, PLM is not consistently reliable in detecting asbestos in non-friable organically bound (NOB) materials. Quantitative transmission electron microscopy (TEM) is currently the only method that can pronounce materials as non-asbestos containing.

Analytical Methodology Alternatives: Your initial request for analysis may not have accounted for recent advances in regulatory requirements or advances in technology that are routinely used in similar situations for other qualified projects. You may have the option to explore additional analysis for further information. Below are a few options, listed as the matrix followed by the appropriate methodology. Also included are links to more information on our website.

Bulk Building Materials that are Non-Friable Organically Bound (NOB) by Gravimetric Reduction techniques employing PLM and TEM: ELAP 198.6 (PLM-NOB), ELAP 198.4 (TEM-NOB)

Loose Fill Vermiculite Insulation, Attic Insulation, Zonolite (copyright), etc.: US EPA 600 R-4/004 (multi-tiered analytical process)
Sprayed On Insulation/Fireproofing with Vermiculite (SOF-V): ELAP 198.8 (PLM-SOF-V)>

CERTIFICATE OF ANALYSIS

Client: Golder Associates Ltd
16820 107 Ave
Edmonton AB T5P 4C3

Client: GOL572

Report Date: 10/27/2017
Report No.: 550052 - PLM
Project: Grit Building
Project No.: 1667963

Soil, sludge, sediment, aggregate, and like materials analyzed for asbestos or other elongated mineral particles (ex. erionite, etc.): ASTM D7521, CARB 435, and other options available

Asbestos in Surface Dust according to one of ASTM's Methods (very dependent on sampling collection technique – by TEM): ASTM D 5755, D5756, or D6480

Various other asbestos matrices (air, water, etc.) and analytical methods are available.

Disclaimers / Qualifiers:

There may be some samples in this project that have a "NOTE:" associated with a sample result. We use added disclaimers or qualifiers to inform the client about something that requires further explanation. Here is a list with highlighted disclaimers that may be pertinent to this project. For a full explanation of these and other disclaimers, please inquire at customerservice@iatl.com.

- 1) Note: No mastic provided for analysis.
- 2) Note: Insufficient mastic provided for analysis.
- 3) Note: Insufficient material provided for analysis.
- 4) Note: Insufficient sample provided for QC reanalysis.
- 5) Note: Different material than indicated on Sample Log / Description.
- 6) Note: Sample not submitted.
- 7) Note: Attached to asbestos containing material.
- 8) Note: Received wet.
- 9) Note: Possible surface contamination.
- 10) Note: Not building material. 1% threshold may not apply.
- 11) Note: Recommend TEM-NOB analysis as per EPA recommendations.
- 12) Note: Asbestos detected but not quantifiable.
- 13) Note: Multiple identical samples submitted, only one analyzed.
- 14) Note: Analyzed by EPA 600/R-93/116. Point Counting detection limit at 0.080%.
- 15) Note: Analyzed by EPA 600/R-93/116. Point Counting detection limit at 0.125%.

Recommendations for Vermiculite Analysis:

Several analytical protocols exist for the analysis of asbestos in vermiculite. These analytical approaches vary depending upon the nature of the vermiculite mineral being tested (e.g. un-processed gange, homogeneous exfoliated books of mica, or mixed mineral composites). Please contact your client representative for pricing and turnaround time options available.

iATL recommends initial testing using the EPA 600/R-93/116 method. This method is specifically designed for the analysis of asbestos in bulk building materials. It provides an acceptable starting point for primary screening of vermiculite for possible asbestos.

Results from this testing may be inconclusive. EPA suggests proceeding to a multi-tiered analysis involving wet separation techniques in conjunction with PLM and TEM gravimetric analysis (EPA 600/R-04/004).

Further information on this method and other vermiculite and asbestos issues can be found at the following: Agency for Toxic Substances and Disease Registry (ATSDR) www.atsdr.cdc.gov, United States Geological Survey (USGS) www.minerals.usgs.gov/minerals/, US EPA www.epa.gov/asbestos. The USEPA also has an informative brochure "Current Best Practices for Vermiculite Attic Insulation" EPA 747F03001 May 2003, that may assist the health and remediation professional.

The following is a summary of the analytical process outlines in the EPA 600/R-04/004 Method:

- 1) **Analytical Step/Method:** Initial Screening by PLM, EPA 600R-93/116
Requirements/Comments: Minimum of 0.1 g of sample. ~0.25% LOQ for most samples.
- 2) **Analytical Step/Method:** Wet Separation by PLM Gravimetric Technique, EPA R-04/004
Requirements/Comments: Minimum 50g** of dry sample. Analysis of "Sinks" only.
- 3) **Analytical Step/Method:** Wet Separation by PLM Gravimetric Technique, EPA R-04/004
Requirements/Comments: Minimum 50g** of dry sample. Analysis of "Floats" only.
- 4) **Analytical Step/Method:** Wet Separation by TEM Gravimetric Technique, EPA R-04/004
Requirements/Comments: Minimum 50g** of dry sample. Analysis of "Sinks" only.
- 5) **Analytical Step/Method:** Wet Separation by TEM Gravimetric Technique, EPA R-04/004

CERTIFICATE OF ANALYSIS

Client: Golder Associates Ltd
16820 107 Ave
Edmonton AB T5P 4C3

Report Date: 10/27/2017
Report No.: 550052 - PLM
Project: Grit Building
Project No.: 1667963

Client: GOL572

Requirements/Comments: Minimum 50g** of dry sample. Analysis of "Suspension" only.

LOQ, Limit of Quantitation estimates for mass and volume analyses.

*With advance notice and confirmation by the laboratory.

**Approximately 1 Liter of sample in double-bagged container (~9x6 inch bag of sample).



APPENDIX B

Waste Water Grit Tanks Building – ACM Inventory

Appendix B
Waste Water Grit Building
ACM Inventory

Included/ Excluded	Floor	Room #	Area Description	Elements	Subelements	Material Description	Accessibility	Suspect?	Sampled?	Asbestos Containing Material?	Condition	Field Notes	Sample Type	Sample ID	Sample Date	Asbestos Type	ACM Product	% of asbestos	Friable	Sprayed-on	Maintenance	Inspection	Priority	Potential for Disturbance	Recommended Action	Quantity	Photograph ID	Labelling Type
Included	L	Throughout	Throughout	Doors	Suspect Fire Door	Suspect Fire Door	High	Yes	No	Potential	Good	Not sampled as damage to the door would affect it's operational requirement.											Inspect and sample if scheduled for removal.					
Included	L	Throughout	Throughout	Door	Regular Door	Non Suspect Door	High	No	No	No	Good	Non-suspect door was observed at the Site.																
Included	L	L100	Pump Room	Walls	Walls	Concrete	High	No	No	No	Good																	
Included	L	L100	Pump Room	Floor	Floor	Concrete	High	No	No	No	Good																	
Included	L	L100	Pump Room	Ceiling	Ceiling	Concrete	High	No	No	No	Good																	
Included	L	L100	Pump Room	Mechanical	Duct Work	Duct Work	High	No	No	No	Good	Bare and uninsulated ducting.																
Included	L	L100	Pump Room	Mechanical	Piping	Metal Pipes	High	No	No	No	Good	Bare or insulated with fibreglass and PVC fittings.																
Included	L	L101	Storage Room	Walls	Walls	Concrete	High	No	No	No	Good																	
Included	L	L101	Storage Room	Floor	Floor	Concrete	High	No	No	No	Good																	
Included	L	L101	Storage Room	Ceiling	Ceiling	Concrete	High	No	No	No	Good																	
Included	L	L101	Storage Room	Mechanical	Duct Work	Dark Grey Duct Mastic	High	No	Yes	No	Good	Uninsulated ducting.	Bulk	V.S. A-005	12-Oct-17													
Included	L	L101	Storage Room	Mechanical	Duct Work	Duct Work	High	No	No	No	Good	Bare and uninsulated ducting.																
Included	L	L102	Grit Truck Bay	Walls	Walls	Concrete	High	No	No	No	Good																	
Included	L	L102	Grit Truck Bay	Floor	Floor	Concrete	High	No	No	No	Good																	
Included	L	L102	Grit Truck Bay	Ceiling	Ceiling	Concrete	High	No	No	No	Good																	
Included	L	L102	Grit Truck Bay	Mechanical	Duct Work	Dark Grey Duct Mastic	High	No	Yes	No	Good	Uninsulated ducting.	Bulk	V.S. A-005	12-Oct-17													
Included	L	L102	Grit Truck Bay	Mechanical	Piping	Metal Pipes	High	No	No	No	Good	Bare or insulated with fibreglass and PVC fittings.																
Included	L	L102	Grit Truck Bay	Electrical	Electrical Panels and Components	Electrical Panels and Components	High	Yes	No	Potential	Good	Not sampled due to safety concerns.												Inspect and sample if scheduled for removal.				
Included	M	Throughout	Throughout	Doors	Suspect Fire Door	Suspect Fire Door	High	Yes	No	Potential	Good	Not sampled as damage to the door would affect it's operational requirement.												Inspect and sample if scheduled for removal.				
Included	M	Throughout	Throughout	Door	Regular Door	Non Suspect Door	High	No	No	No	Good	Non-suspect door was observed at the Site.																
Included	M	100	Grit Treatment	Walls	Walls	Cinderblock	High	No	No	No	Good																	
Included	M	100	Grit Treatment	Floor	Floor	Concrete	High	No	No	No	Good																	
Included	M	100	Grit Treatment	Ceiling	Ceiling	Concrete	High	No	No	No	Good																	
Included	M	100	Grit Treatment	Windows	Caulking	Grey Caulking	High	No	Yes	No	Good	On window frames.	Bulk	A-007	12-Oct-17													
Included	M	100	Grit Treatment	Mechanical	Duct Work	Duct Work	High	No	No	No	Good	Bare and uninsulated ducting.																
Included	M	100	Grit Treatment	Mechanical	Piping	Metal Pipes	High	No	No	No	Good	Bare or insulated with fibreglass and PVC fittings.																
Included	M	100	Grit Treatment	Miscellaneous	Caulking	Grey Caulking	High	No	Yes	No	Good	Building caulking.	Bulk	A-021	12-Oct-17													
Included	M	100	Grit Treatment	Miscellaneous	Firestop	Red Firestop	High	No	Yes	No	Good		Bulk	V.S.A-004	12-Oct-17													
Included	C	Throughout	Throughout	Doors	Suspect Fire Door	Suspect Fire Door	High	Yes	No	Potential	Good	Not sampled as damage to the door would affect it's operational requirement.												Inspect and sample if scheduled for removal.				
Included	C	Throughout	Throughout	Door	Regular Door	Non Suspect Door	High	No	No	No	Good	Non-suspect door was observed at the Site.																
Included	C	C100	Corridor	Walls	Walls	Concrete	High	No	No	No	Good																	
Included	C	C100	Corridor	Floor	Floor	Concrete	High	No	No	No	Good																	
Included	C	C100	Corridor	Ceiling	Ceiling	Concrete	High	No	No	No	Good																	
Included	C	C100	Corridor	Ceiling	Ceiling	Fibreglass Panels	High	No	Yes	No	Good	Black mastic on fibreglass sampled.	Bulk	A-020	12-Oct-17													
Included	C	C100	Corridor	Mechanical	Duct Work	Dark Grey Duct Mastic	High	No	Yes	No	Good	Uninsulated ducting.	Bulk	V.S. A-005	12-Oct-17													
Included	C	C100	Corridor	Mechanical	Piping	Metal Pipes	High	No	No	No	Good	Bare or insulated with fibreglass and PVC fittings.																
Included	C	C100	Corridor	Miscellaneous	Caulking	Grey Caulking	High	No	Yes	No	Good	On concrete.	Bulk	A-019	12-Oct-17													
Included	C	C101	MCC Room	Walls	Walls	Cinderblock	High	No	No	No	Good																	
Included	C	C101	MCC Room	Walls	Walls	Concrete	High	No	No	No	Good																	
Included	C	C101	MCC Room	Floor	Floor	Concrete	High	No	No	No	Good																	
Included	C	C101	MCC Room	Ceiling	Ceiling	Concrete	High	No	No	No	Good																	
Included	C	C101	MCC Room	Ceiling	Ceiling	Brown Mastic Pucks	High	No	Yes	No	Good		Bulk	A-003	12-Oct-17													
Included	C	C101	MCC Room	Mechanical	Duct Work	Dark Grey Duct Mastic	High	No	Yes	No	Good		Bulk	A-005	12-Oct-17													
Included	C	C101	MCC Room	Mechanical	Duct Work	Light Grey Duct Mastic	High	No	Yes	No	Good		Bulk	A-006	12-Oct-17													
Included	C	C101	MCC Room	Miscellaneous	Firestop	White Firestop	High	No	Yes	No	Good		Bulk	V.S. A-002	12-Oct-17													
Included	C	C101	MCC Room	Miscellaneous	Firestop	Red Firestop	High	No	Yes	No	Good		Bulk	A-004	12-Oct-17													
Included	C	C101	MCC Room	Electrical	Electrical Panels and Components	Electrical Panels and Components	High	Yes	No	Potential	Good	Not sampled due to safety concerns.												Inspect and sample if scheduled for removal.				
Included	C	C102	Washroom	Walls	Walls	Cinderblock	High	No	No	No	Good																	
Included	C	C102	Washroom	Walls	Walls	Concrete	High	No	No	No	Good																	
Included	C	C102	Washroom	Floor	Floor	Concrete	High	No	No	No	Good																	
Included	C	C102	Washroom	Ceiling	Ceiling	Concrete	High	No	No	No	Good																	
Included	C	C102	Washroom	Mechanical	Piping	Metal Pipes	High	No	No	No	Good	Bare or insulated with fibreglass and PVC fittings.																
Included	C	C103	Corridor	Walls	Walls	Cinderblock	High	No	No	No	Good																	
Included	C	C103	Corridor	Walls	Walls	Concrete	High	No	No	No	Good																	
Included	C	C103	Corridor	Floor	Floor	Concrete	High	No	No	No	Good																	
Included	C	C103	Corridor	Ceiling	Ceiling	Concrete	High	No	No	No	Good																	
Included	C	C103	Corridor	Miscellaneous	Caulking	Grey Caulking	High	No	Yes	No	Good	On concrete floor.	Bulk	A-001	12-Oct-17													
Included	C	C103	Corridor	Miscellaneous	Firestop	White Firestop	High	No	Yes	No	Good		Bulk	A-002	12-Oct-17													
Included	C	C103	Corridor	Mechanical	Piping	Metal Pipes	High	No	No	No	Good	Bare or insulated with fibreglass and PVC fittings.																
Included	E	Exterior	Exterior	Walls	Walls	Brick	High	No	Yes	No	Good	Brick mortar sampled.	Bulk	A-012, A-013, A-014, A-015, A-016	12-Oct-17													
Included	E	Exterior	Exterior	Windows	Caulking	Grey Caulking	High	No	Yes	No	Good	On window frames.	Bulk	A-009	12-Oct-17													
Included	E	Exterior	Exterior	Miscellaneous	Firestop	Grey Putty	High	No	Yes	No	Good		Bulk	A-008	12-Oct-17													



APPENDIX C

Floor Plans

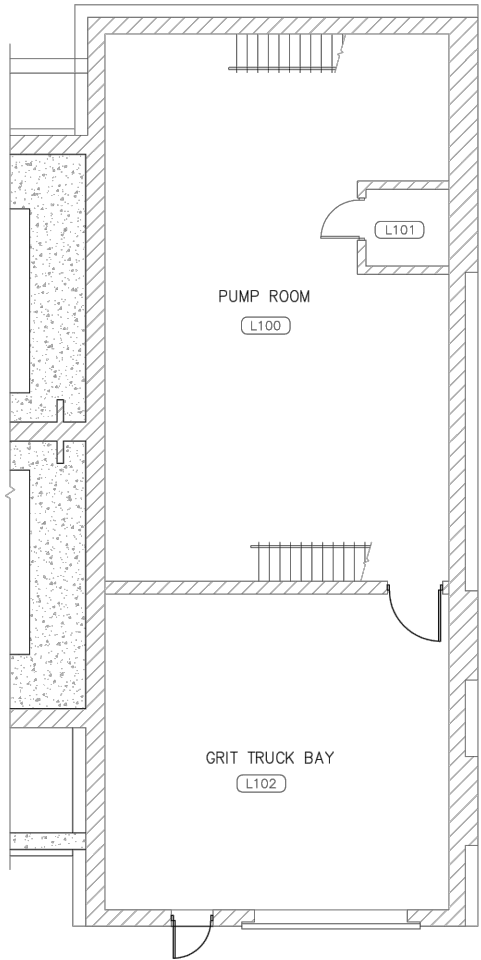

LEGEND

● # ASBESTOS SAMPLE LOCATION

NOTE(S)

1. ASBESTOS IS A CARCINOGEN. DO NOT BREATHE ASBESTOS DUST.
2. ASBESTOS-CONTAINING MATERIALS WERE NOT OBSERVED ON SITE DURING THE ASSESSMENT.

REFERENCE(S)

PLAN OBTAINED FROM INFRASTRUCTURE SERVICES DEPARTMENT CITY OF SASKATOON. DATED: 24/11/2016

CLIENT
CITY OF SASKATOON

CONSULTANT



YYYY-MM-DD 2017-12-04

DESIGNED KH

PREPARED VI

REVIEWED KH

APPROVED AG

SCHEMATIC ONLY, NOT TO SCALE

PROJECT
ASBESTOS ASSESSMENT
WASTE WATER GRIT TANKS BUILDING
470 WHITESWAN DRIVE

TITLE
LOWER FLOOR

PROJECT NO.	CONTROL	REV.	FIGURE
1667963	1000-HM-0003	0	1

IF THIS MEASUREMENT DOES NOT MATCH WHAT IS SHOWN, THE SHEET SIZE HAS BEEN MODIFIED FROM ANSI A

26 mm

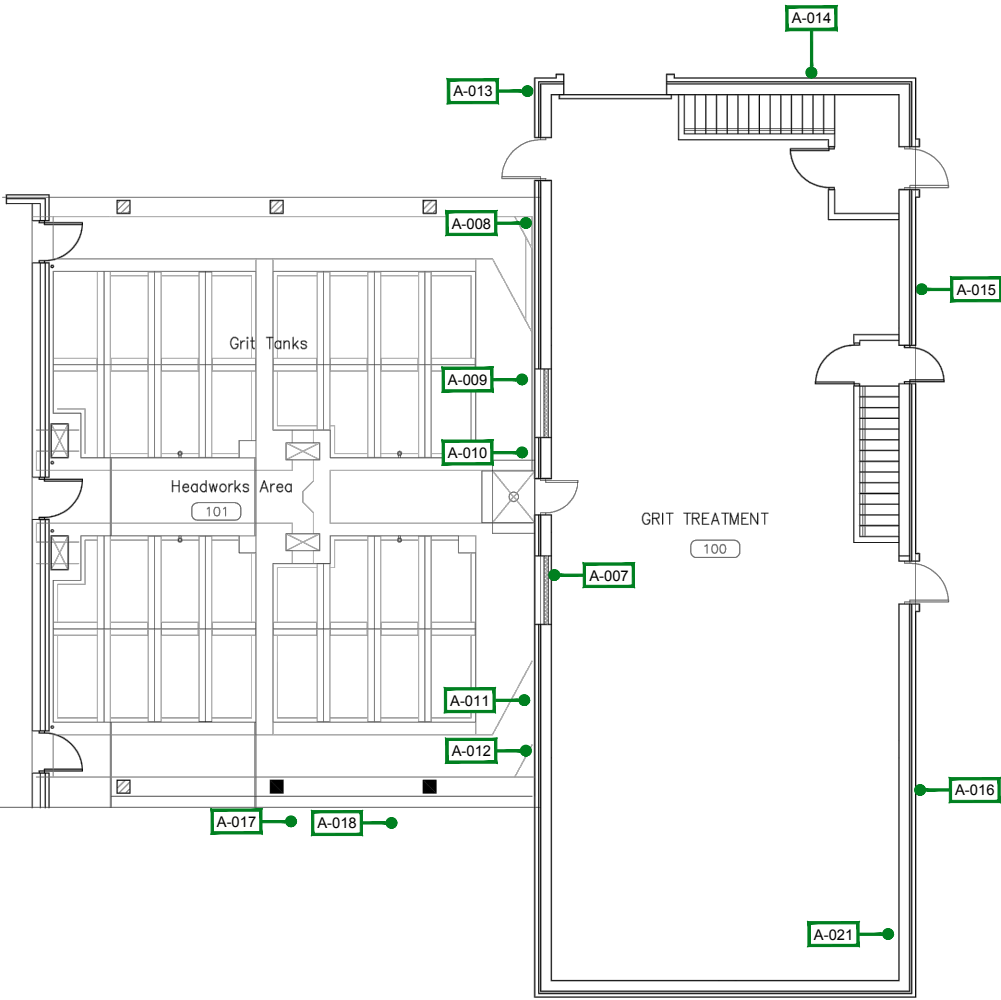

LEGEND

● # ASBESTOS SAMPLE LOCATION

SCHEMATIC ONLY, NOT TO SCALE

CLIENT
CITY OF SASKATOON

PROJECT
ASBESTOS ASSESSMENT

NOTE(S)

1. ASBESTOS IS A CARCINOGEN. DO NOT BREATHE ASBESTOS DUST.
2. ASBESTOS-CONTAINING MATERIALS WERE NOT OBSERVED ON SITE DURING THE ASSESSMENT.

REFERENCE(S)

PLAN OBTAINED FROM INFRASTRUCTURE SERVICES DEPARTMENT CITY OF SASKATOON. DATED: 24/11/2016

CONSULTANT



YYYY-MM-DD 2017-12-04

DESIGNED KH

PREPARED VI

REVIEWED KH

APPROVED AG

TITLE
MAIN FLOOR

PROJECT NO.
1667963

CONTROL
1000-HM-0004

REV.
0

FIGURE
2

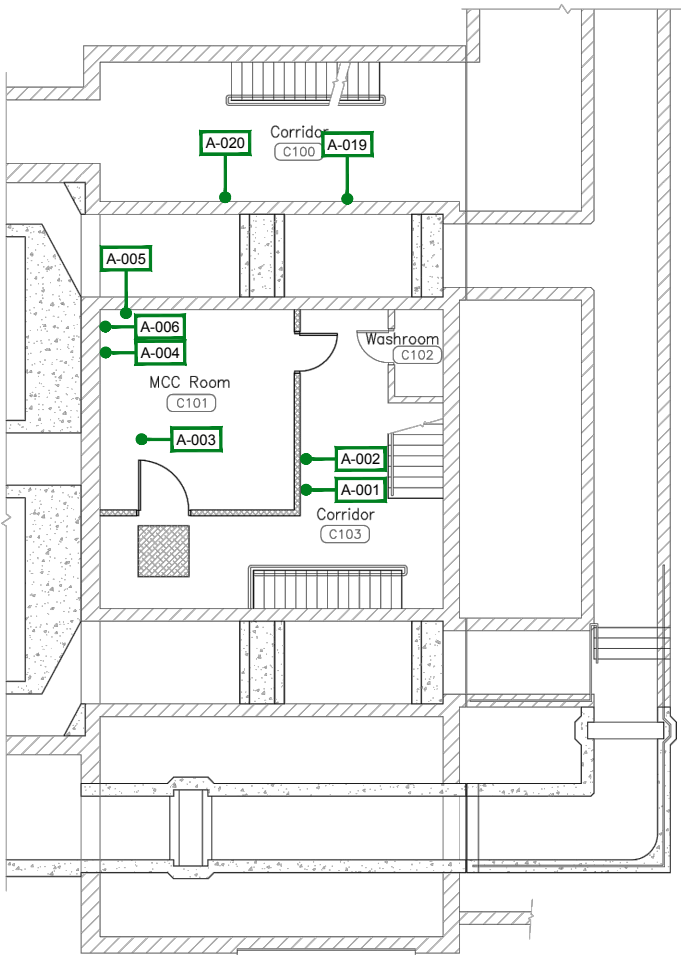

LEGEND

● # ASBESTOS SAMPLE LOCATION

NOTE(S)

1. ASBESTOS IS A CARCINOGEN. DO NOT BREATHE ASBESTOS DUST.
2. ASBESTOS-CONTAINING MATERIALS WERE NOT OBSERVED ON SITE DURING THE ASSESSMENT.

REFERENCE(S)

PLAN OBTAINED FROM INFRASTRUCTURE SERVICES DEPARTMENT CITY OF SASKATOON. DATED: 24/11/2016

CLIENT
CITY OF SASKATOON

CONSULTANT



YYYY-MM-DD 2017-12-04

DESIGNED KH

PREPARED VI

REVIEWED KH

APPROVED AG

SCHEMATIC ONLY, NOT TO SCALE

PROJECT
ASBESTOS ASSESSMENT
WASTE WATER GRIT TANKS BUILDING
470 WHITESWAN DRIVE

TITLE
CHANNEL FLOOR

PROJECT NO.	CONTROL	REV.	FIGURE
1667963	1000-HM-0001	0	3

IF THIS MEASUREMENT DOES NOT MATCH WHAT IS SHOWN, THE SHEET SIZE HAS BEEN MODIFIED FROM: ANSI A

26 mm

As a global, employee-owned organisation with over 50 years of experience, Golder Associates is driven by our purpose to engineer earth's development while preserving earth's integrity. We deliver solutions that help our clients achieve their sustainable development goals by providing a wide range of independent consulting, design and construction services in our specialist areas of earth, environment and energy.

For more information, visit golder.com

Africa	+ 27 11 254 4800
Asia	+ 86 21 6258 5522
Australasia	+ 61 3 8862 3500
Europe	+ 356 21 42 30 20
North America	+ 1 800 275 3281
South America	+ 56 2 2616 2000

solutions@golder.com
www.golder.com

Golder Associates Ltd.
16820 107 Avenue
Edmonton, Alberta, T5P 4C3
Canada
T: +1 (780) 483 3499

