

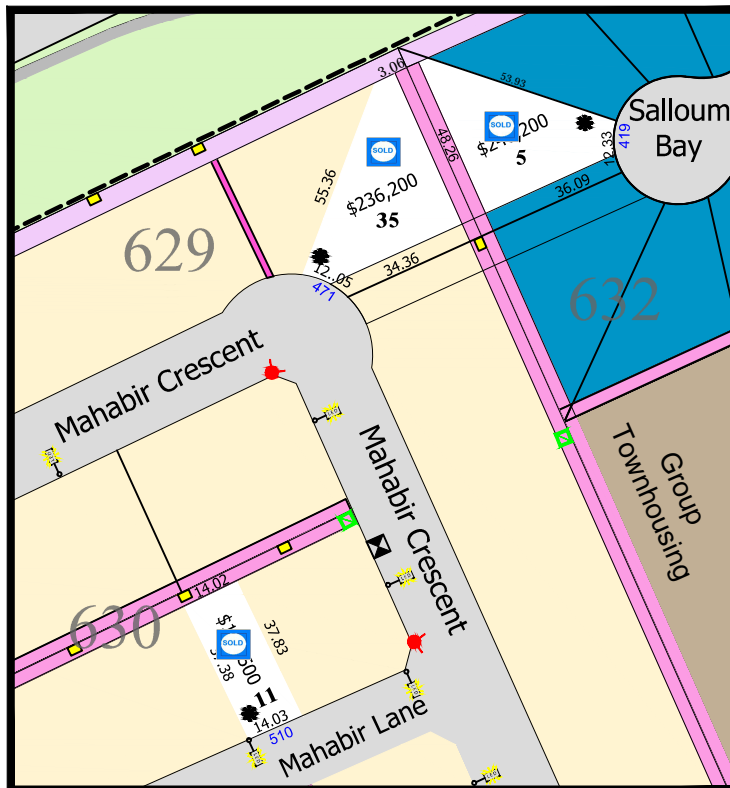

# EVERGREEN

## Returned Lot Map Johns Road, Mahabir Crescent, Lane, Salloum Bay

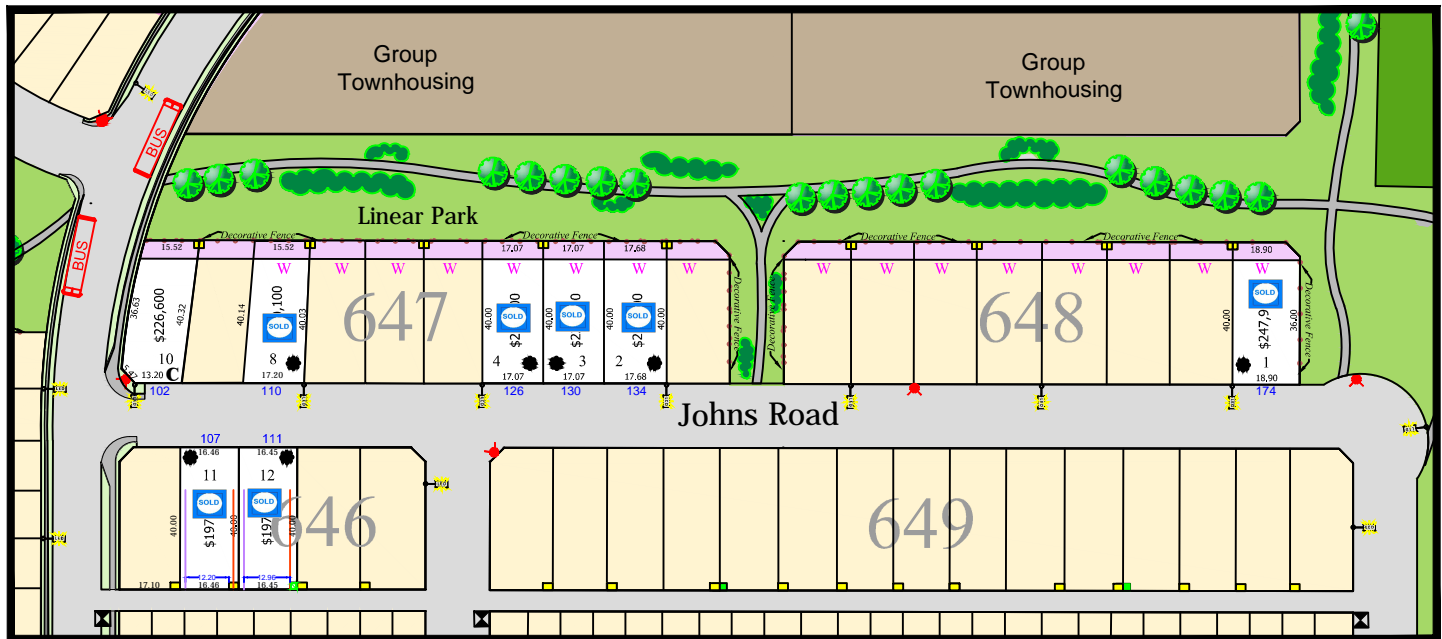

### Legend:

Civic Addresses	1234
Corner Garage Location	C
Easement 1.5m	
Easement 3m	
Easement 5m	
Easment Other	
Previous Lot Draw	
Transformer(2.0m x 2.0m)	
Utility Pedestal(2.8x2.0)	
Pre-designated Lots (Residential Care Home - Type II; Daycare Centre; Preschool)	
Garage Pad Maximum Width (Between Utilities)	← 6.14 →
Underground Gas Line accomodation	
Underground Power Line accomodation	
Fire Hydrant	
Lots with no slope req.	
Garage Location	
LED Light Standard	
Mail Boxes	
Walk Out	
Temporary Water Circulator	
Chain Fence	
Decorative Fence	
Masonry Fence	
Proposed Bus stops	



**City of  
Saskatoon**

**AF Saskatoon Land - March 2016**

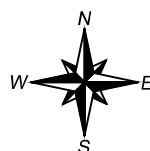

Note: The Saskatoon Land does not guarantee the accuracy of this plan. Lot dimensions and the location of other features are compiled from available information and are subject to change without notice. Park and buffer renderings are for illustrative purposes only and does not represent what will be constructed. To ensure accuracy, please refer to the Registered Plan of Survey. Distances are in meters unless shown otherwise. Do not scale.