

SHAW CENTRE • 122 Bowlit Crescent

For bookings and rental rates, call Customer Service at 306.975.7744 or email facilitybookings@saskatoon.ca.

Internationally recognized, this state-of-the-art facility brings the excitement of elite level aquatics to Saskatoon. Book your next water polo, speed swimming, artistic swimming or diving event and join the legions of talented athletes who compete here. The Shaw Centre regularly hosts provincial, regional and national events in all aquatic disciplines throughout the year.

Shaw Centre also has a Leisure Pool with water features, a rapids area, waterslide and hot tubs. The waterslide is fun for all with a shallow exit that is perfect for little ones.

Walkers, joggers, runners and strollers are welcome on the Walking Track. The Fitness Centre overlooks the pool and offers excellent variety for your workout.

In addition, the Shaw Centre has a variety of meeting spaces, making it an ideal venue for meetings, seminars, clinics and more.

Competitive Pool

- Designed to meet/exceed World aquatics regulations for hosting national and international competitions
- 10-lane, 50 m high performance pool
- 3, 5, 7.5 & 10 m diving platforms
- 3 to 5 m deep
- Spectator seating for up to 750 people

Family (Leisure) & Warm-up Pools

- 6, 25 m lanes
- 0-depth beach entry with rapids
- 252 ft waterslide
- Children's slide and water toys
- Portable Aquatic Lift
- Hot tubs

Meeting Rooms

- Table and chairs available
- Two meeting room options with capacities of 25-50 people.
- Smart TV
- Hardwired and WiFi internet connections
- Direct access to Leisure Pool area
- Projector and screen
- Flip charts and whiteboard

Walking Track

- 3 lanes, 165 m

Multi-purpose Room

- Sprung fitness floor
- Equipped with sink for multi-functional use
- Mirrored wall

Gymnasium

- Access to basketball, volleyball and badminton equipment



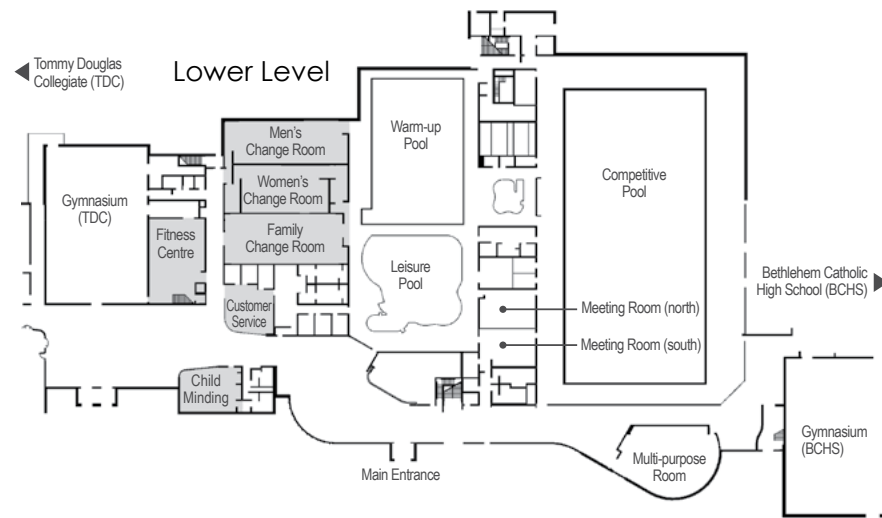

Other features

- Drop-in Fitness Classes (aquatic & dryland)
- Fitness Centre
- Child Minding/Indoor Playground
- Multi-purpose Fields (pg. 22)
- Playground (outdoor)
- WiFi access
- Vending Machines

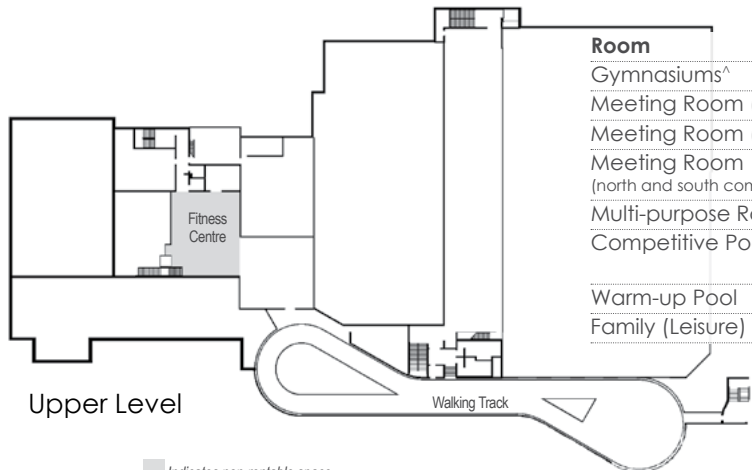

Room	Size	Dimensions	Capacity
Gymnasiums [^]	5,369 sq ft	59' x 91'	300
Meeting Room (north)	747.5 sq ft	23' x 32.5'	25
Meeting Room (south)	650 sq ft	20' x 32.5'	25
Meeting Room (north and south combined)	1,397.5 sq ft	43' x 32.5'	50
Multi-purpose Room	2,072 sq ft	37' x 56'	60
Competitive Pool	10, 50 m or 20, 25 m lanes		440
Warm-up Pool	6, 25 m lanes		160
Family (Leisure) Pool			140

[^]Dimensions per gymnasium (Tommy Douglas Collegiate and Bethlehem Catholic High School).

■ Indicates non-rentable space.