

# Leisure Centres

## COSMO CIVIC CENTRE • 3130 Laurier Drive

For bookings and rental rates, call Customer Service at 306.975.3344 or email [facilitybookings@saskatoon.ca](mailto:facilitybookings@saskatoon.ca).

This versatile venue can accommodate many types of athletic bookings and group functions. The large multi-purpose room features a studio-style mirrored wall and roll-out mats, and gymnasium rentals include sports equipment. Racquetball and walleyball court and the full-surface skating rink are also available to rent.

Cosmo's theatre has great acoustics making it ideal for meetings, lectures, clinics or performing arts.

### Gymnasium

- Tile floor • Sound system
- Small kitchen • Score clock
- Tables and chairs
- Access to sports equipment
- Stage

### Skating Rink

- Available for ice rental from October through March. See page 26 for details

### Racquetball & Walleyball Court

- 60-minute booking options
- Racquet, ball and eyewear rentals are available

### Meeting Rooms

- Two meeting room options with capacities of 25-50 people
- Tables and chairs available
- Smart TV
- Kitchen (off Room A)
- Curtain partition

### Multi-purpose Room

- Ideal for meetings, social functions, martial arts and defence training
- Tables and chairs available
- Tile floor • Mirrored wall
- Sound system

### Theatre

- Ideal for meetings, lectures, clinics or performing and literary arts
- New theatre seats with tabletops
- Data projector and screen, built-in sound system with wireless microphones, TV, DVD player and flip chart
- Good acoustics. Centre of ceiling is cellulose acoustic fibre and front/back walls are lined with acoustic carpet

### Studio

- Ideal for meetings, dance and celebrations
- Mirrored walls
- Access to second floor kitchen



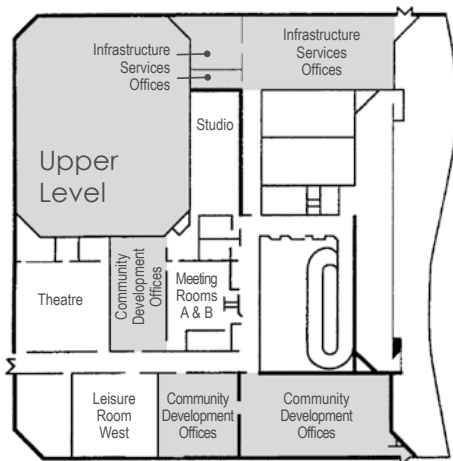
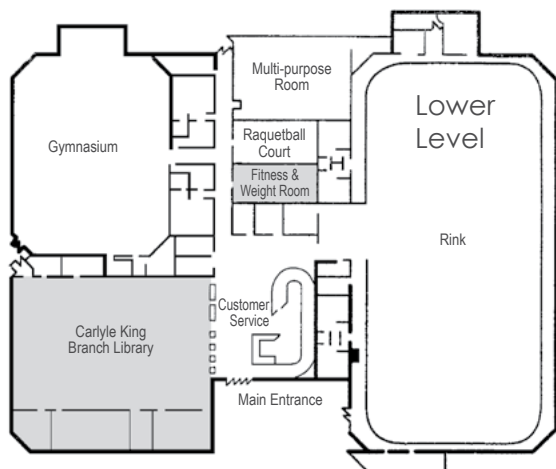

■ Indicates non-rentable space.



### Other features

- Fitness & Weight Room
- Carlyle King Branch Library
- Drop-in Fitness Classes (dryland)
- Public Skating (winter months)
- WiFi access
- Vending Machines

Room	Size	Dimensions	Capacity
Gymnasium	7,448 sq ft	76' x 98'	475
Meeting Room A	414 sq ft	18' x 23'	25*
Meeting Room B	529 sq ft	23' x 23'	25*
Meeting Room A & B Combined	943 sq ft	41' x 23'	50*
Multi-purpose Room	2,160 sq ft	40' x 54'	100*
Theatre	1,600 sq ft	40' x 40'	150
Studio	1,155 sq ft	21' x 55'	30
Leisure Room West	1,365 sq ft	39' x 35'	40

\*Capacity is based on standard meeting set-up with tables and chairs.