



## COSMO CIVIC CENTRE • 3130 Laurier Drive

For bookings and rental rates, call Customer Service at 306.975.3344 or fax 306.975.7870.

This versatile venue can accommodate many types of athletic bookings and group functions. The large multi-purpose room features a studio-style mirrored wall and roll-out mats, and gymnasium rentals include sports equipment. Racquetball and walleyball court and the full-surface skating rink are also available to rent.

Cosmo's theatre has great acoustics making it ideal for meetings, lectures, clinics or performing arts.

### Gymnasium

- Tile floor • Sound system
- Small kitchen • Score clock
- Tables and chairs
- Access to sports equipment
- Stage

### Skating Rink

- Available for ice rental from October through March.

### Racquetball & Walleyball Court

- 60-minute booking options
- Racquet, ball and eyewear rentals are available

### Meeting Rooms

- Two meeting room options with capacities of 25-50 people
- Tables and chairs available
- Smart TV
- Kitchen (off Room A)
- Curtain partition

### Multi-purpose Room

- Ideal for meetings, social functions, martial arts and defence training
- Tables and chairs available
- Tile floor
- Mirrored wall
- Sound system

### Theatre

- Ideal for meetings, lectures, clinics or performing and literary arts
- New theatre seats with tabletops
- Data projector and screen, built-in sound system with wireless microphones, TV, DVD player and flip chart
- Good acoustics. Centre of ceiling is cellulose acoustic fibre and front/back walls are lined with acoustic carpet

See next page for facility map and room dimensions.



Theatre



Multi-purpose Room



Skating Rink



Gymnasium



## COSMO CIVIC CENTRE • 3130 Laurier Drive

For bookings and rental rates, call Customer Service at 306.975.3344 or fax 306.975.7870.

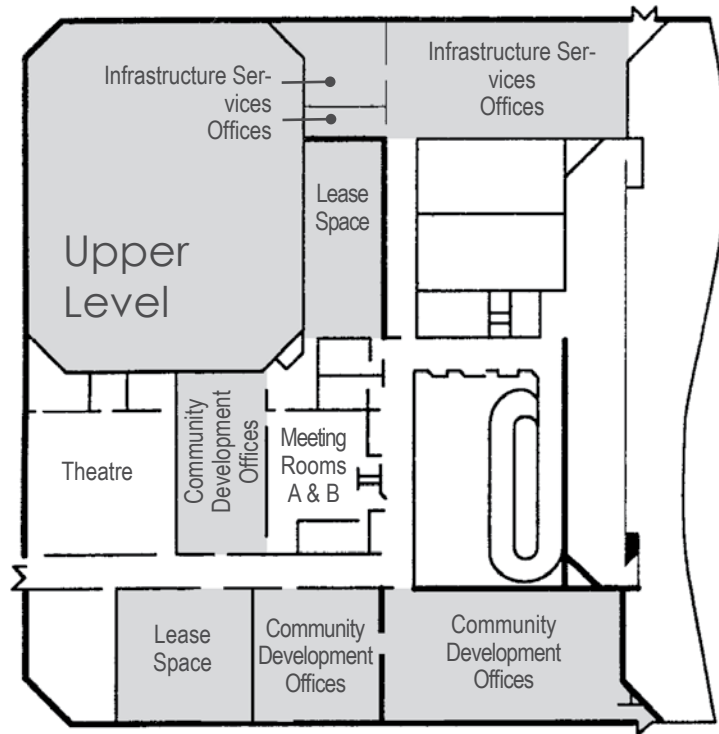

■ Indicates non-rentable space.

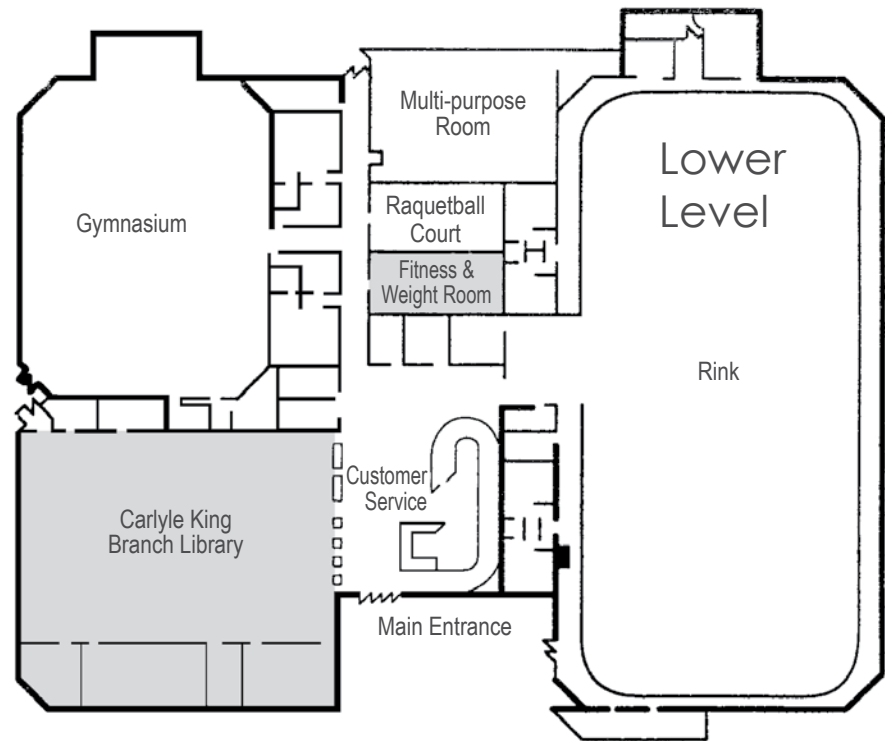

Room	Size	Dimensions	Capacity
Gymnasium	7,448 sq ft	76' x 98'	475
Meeting Room A	414 sq ft	18' x 23'	25*
Meeting Room B	529 sq ft	23' x 23'	25*
Meeting Room A & B Combined	943 sq ft	41' x 23'	50*
Multi-purpose Room	2,160 sq ft	40' x 54'	100*
Theatre	1,600 sq ft	40' x 40'	150

\*Capacity is based on standard meeting set-up with tables and chairs.

### Other features

- Fitness & Weight Room
- Carlyle King Branch Library
- Drop-in Fitness Classes (dryland)
- Public Skating (winter months)
- Complimentary Shaw Go WiFi access
- Vending Machines